

Selection guide page 4/2

Beacons and indicator banks, Ø 45 mm Optimum

- Illuminated beacons, Harmony type XVD LS, miniature page 4/5
- Indicator banks, Harmony type XVM
 - Pre-cabled indicator banks page 4/9
 - Customer assembled indicator banks, accessories. page 4/11

Indicator banks Ø 50 mm Universal, Harmony type XVP C

- Indicator banks for customer assembly, up to 5 units
 - Illuminated units for BA 15 d bulb or LED page 4/17
 - Illuminated and audible units page 4/18
 - Base units, covers and accessories page 4/19

Beacons and indicator banks Ø 70 mm Optimum, Harmony type XVE

- Illuminated beacons. page 4/25
- Indicator banks for customer assembly page 4/26
- Separate components for beacons and indicator banks page 4/27

Beacons and indicator banks Ø 70 mm Universal, Harmony type XVB

- Illuminated beacons, type XVB L
 - For incandescent bulbs or LEDs (BA 15d base fitting) page 4/34
 - With LED light source page 4/35
 - With "flash" discharge tube page 4/36
- Indicator banks, type XVB C (for customer assembly, up to 5 units)
 - Illuminated units for incandescent bulbs or LEDs (BA 15 d base fitting) page 4/37
 - Illuminated units with integral LED. page 4/38
 - Illuminated units with integral "flash" discharge tube. page 4/39
 - Audible units, base units, cover, accessories page 4/40
- Accessories for beacons and indicator banks type XVB page 4/41

Beacons and indicator banks Ø 70 mm Application, Harmony type XVD

- Illuminated beacons for customer assembly page 4/48
- Indicator banks (variable composition of up to 5 units), for customer assembly
 - Illuminated units. page 4/49
 - Audible units, base units, accessories. page 4/50
- Accessories for beacons and indicator banks page 4/51

Rotating mirror beacons and sirens

- Rotating mirror beacons, type XVR. page 4/55
- Sirens, type XVS page 4/57

Harmony type XV

Optimum



Type of products	Pilot lights	Miniature beacons	Indicator banks	Beacons and indicator banks
Diameter (mm)	Ø 25	Ø 45	Ø 45	Ø 70
Features	Complete pre-cabled products, height 55 mm	Complete products	Complete pre-cabled products or for customer assembly	Products for customer assembly
Description of the range	–	Illuminated beacons - steady light, - with "flash" discharge tube	–	Illuminated beacons - steady light, - flashing light, - with "flash" discharge tube
Light sources	Incandescent bulb LED "Flash" discharge tube Halogen bulb	–	Variable composition indicator banks for customer assembly of up to 5 units: - illuminated units with steady light, flashing light or "flash" discharge tube signalling, - audible units	–
Degree of protection conforming to IEC 529 and NF C 20-010	IP 40	IP 40	IP 40	IP 42 mounted vertically, IP 40 for other positions. IP 54 with reinforced protection (using sealing kit)
Colours of illuminated units	<input type="checkbox"/> Green <input type="checkbox"/> Red <input type="checkbox"/> Clear <input type="checkbox"/> Yellow	<input type="checkbox"/> Green <input type="checkbox"/> Red <input type="checkbox"/> Orange <input type="checkbox"/> Blue <input type="checkbox"/> Clear <input type="checkbox"/> Yellow	<input type="checkbox"/> Red <input type="checkbox"/> Green <input type="checkbox"/> Orange <input type="checkbox"/> Blue <input type="checkbox"/> Clear	<input type="checkbox"/> Green <input type="checkbox"/> Red <input type="checkbox"/> Orange <input type="checkbox"/> Blue <input type="checkbox"/> Clear
Connection	Flying leads, length 360 mm	Screw clamp terminals	Screw terminals	Screw clamp terminals
Support panel drilling or cut-out	Ø 22 or Ø 30	3 x Ø 3.3 or M3	Mounted on bracket: 2 x Ø 9	Direct mounting: 4 x Ø 5.5 or M5
Type references	XV1 CA	XVD LS	XVM ▲	XVE L, XVE C
Page(s)	Please consult your Regional Sales Office	4/5	4/9 to 4/11	4/25 and 4/26

▲ Available: 1st quarter 2005.

Universal		Application		
				
Indicator banks	Beacons and indicator banks		Rotating mirror beacon	Sirens
Ø 50	Ø 70	Ø 70	Ø 165	Ø 92
Products for customer assembly			Complete products	
–	Illuminated beacons - steady light, - flashing light, - with "flash" discharge tube		Rotating mirror beacon - with halogen bulb, - with incandescent bulb	Power - 106 dB, single tone, - 106 dB, 2 tone
Variable composition indicator banks for customer assembly of up to 5 units: - illuminated units with steady light, flashing light or "flash" discharge tube signalling - audible units			–	–
■	■	■	■	–
■ "PROTECTED LED"	■ "PROTECTED LED"	■ "PROTECTED LED"	–	–
■	■	■	–	–
–	–	–	■	–
IP 65	IP 65 (mounted on fixing base XVB Z0●) IP 66 (mounted on base unit)	IP 40	IP 65	IP 40
<input type="checkbox"/> Green <input type="checkbox"/> Red <input type="checkbox"/> Orange <input type="checkbox"/> Blue <input type="checkbox"/> Clear <input type="checkbox"/> Yellow			<input type="checkbox"/> Green <input type="checkbox"/> Red <input type="checkbox"/> Orange <input type="checkbox"/> Blue <input type="checkbox"/> Yellow	–
Screw clamp terminals			Push-on connectors	Screw terminals
Direct mounting: 2 x Ø 4.2 x 16 Mounted on support tube: 4 x M5	Direct mounting: 2 x Ø 4.5 or M4 Mounted on support tube: 4 x Ø 5.5 or M5		3 x Ø 6.5	
XVP C	XVB L, XVB C	XVD L, XVD C	XVR	XVS
4/17 to 4/19	4/34 to 4/41	4/48 to 4/51	4/55	4/57

Beacons and indicator banks

Illuminated beacons Ø 45 mm Optimum,
Harmony type XVD LS, miniature

Presentation

Miniature illuminated beacons XVD LS are suitable for installation on small machines for short distance signalling of the process status.

Characteristics

Product certifications	Standard version, CSA, UL	V	Pending
Conformity to standards			IEC/EN 60947-5-1
Protective treatment	Standard version		"TC"
Ambient air temperature	For storage	°C	- 40...+ 70
	For operation	°C	With incandescent bulb: - 25...+ 70 With "flash" discharge tube: - 10...+ 50
Electric shock protection	Conforming to IEC 536		Class II
Degree of protection	Conforming to IEC 529 and NF C 20-010		IP 40
Material	Illuminated units		Polycarbonate
	Base unit and cover		Glass-reinforced polyamide and polycarbonate
Rated insulation voltage (Ui)	Conforming to IEC 947-1	V	250
Consumption	With "flash" discharge tube circuit	mA	≈ 24: < 65
		mA	~ 120: < 15
		mA	~ 230: < 19
Rated impulse withstand voltage	Conforming to IEC 947-1	kV	U imp = 4
Light source	Illuminated units with steady light		Incandescent bulbs with BA 15d base fitting, maximum power 5 W
Illuminating power	Illuminated units with discharge circuit (flash lamp with integral tube)	cds	1.4 (integral high intensity tube) with clear lens unit
Connection	Maximum clamping capacity on protected, ready-to-tighten, screw and captive cable clamp terminals	mm²	1 x 1.5 with cable end
Cable entry			For cable gland n° 7 (DIN Pg 7), not included

Dimensions

Panel cut-out for direct fixing

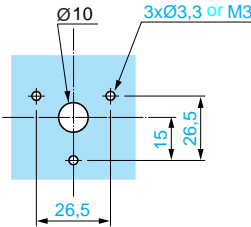
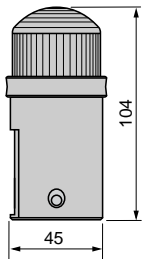

Beacons and indicator banks

Illuminated beacons Ø 45 mm Optimum,
Harmony type XVD LS, miniature



XVD LS●●

Beacons with steady light signalling

Description	Light source, to be ordered separately	Colour	Reference	Weight kg
Complete unit comprising: - 1 illuminated unit - 1 base unit (direct fixing)	Incandescent bulb 5 W max. 230 V max.	Green	XVD LS33	0.080
		Red	XVD LS34	0.080
		Orange	XVD LS35	0.080
		Blue	XVD LS36	0.080
		Clear	XVD LS37	0.080
		Yellow	XVD LS38	0.080

Bulbs for beacons with steady light signalling

Description	Characteristics		Sold in lots of	Unit reference	Weight kg
Incandescent bulbs BA 15d base fitting	24 V	4 W	10	DL1 BEBS	0.090
	120 V	5 W	10	DL1 BEGS	0.090
	230 V	5 W	10	DL1 BEMS	0.090

Beacons with 0.5 Joule "flash" discharge tube

Description	Light source (included)	Colour	Reference	Weight kg
Complete unit comprising: - 1 illuminated unit - 1 base unit (direct fixing)	"Flash" discharge tube ~ 24 V	Green	XVD LS6B3	0.085
		Red	XVD LS6B4	0.085
		Orange	XVD LS6B5	0.085
		Blue	XVD LS6B6	0.085
		Clear	XVD LS6B7	0.085
		Yellow	XVD LS6B8	0.085
		Green	XVD LS6G3	0.085
		Red	XVD LS6G4	0.085
	"Flash" discharge tube ~ 120 V	Orange	XVD LS6G5	0.085
		Blue	XVD LS6G6	0.085
		Clear	XVD LS6G7	0.085
		Yellow	XVD LS6G8	0.085
		Green	XVD LS6M3	0.085
		Red	XVD LS6M4	0.085
		Orange	XVD LS6M5	0.085
		Blue	XVD LS6M6	0.085
	"Flash" discharge tube ~ 230 V	Clear	XVD LS6M7	0.085
		Yellow	XVD LS6M8	0.085

Beacons and indicator banks

Indicator banks Ø 45 mm Optimum,
Harmony type XVM

4



Indicator banks XVM supplied complete and pre-cabled, with 2, 3 or 4 illuminated units and fitted with buzzer

Presentation

Ø 45 mm indicator banks XVM are available in 2 forms:

- **Supplied complete**, with 2, 3 or 4 illuminated units, with or without buzzer.
 - Pre-assembled, they are pre-cabled and fitted with a fixing base mounted on a bracket for vertical mounting on their support.
 - These pre-assembled and pre-cabled indicator banks cannot be modified since the wiring connections are permanent (soldered).
- But they are also available as separate components for **customised assembly** to suit the requirements of the customer.

Light signalling

5 catalogued lens unit colours available: red, orange, green, clear or blue.

These illuminated units incorporate a BA 15d base that can be fitted (by simple 15° rotation) with the choice of light source:

- 1 incandescent bulb,
- 1 LED, or
- 1 "flash" discharge tube.

These 3 types of light source enable:

- steady light signalling using an incandescent bulb or an LED (1),
- flashing light signalling using an LED,
- "flash" light signalling using a "flash" discharge tube.

(1) A flashing function can also be obtained from a steady light LED by using a PLC output signal.

Audible signalling

The indicator bank is supplied with or without an audible (buzzer) unit depending on the configuration required. The buzzer is housed in the base unit of the indicator bank.

- There is also a potentiometer in the base unit for adjusting the volume of the audible signal, up to a value of 80 decibels.
- A selector enables the choice of signalling: continuous or intermittent tone.

Modularity

Indicator banks XVM are supplied pre-assembled and pre-cabled, with or without an audible (buzzer) unit, but they can also be assembled using separate components, all of which are catalogued listed:

- either 5 illuminated units maximum, or
- a base unit with integral buzzer and 4 illuminated units.

The light sources (incandescent bulb, LED or "flash" discharge tube) are interchangeable. This enables, for example, the replacement of incandescent bulbs initially fitted in an indicator bank by LEDs (longer service life) in order to reduce maintenance operations. The current consumption of LEDs is very low and consequently, their usage has a definite effect on the reduction of power consumption.

The illuminated units easily fit together and electrical connections are made automatically.

Connections in the base unit for indicator banks assembled by the customer are made to a screw terminal block.

Cabling

Indicator banks XVM supplied complete feature referenced wires with a wiring instructions label. Each illuminated unit of the indicator bank is identified by a different wire colour.

Beacons and indicator banks

Indicator banks Ø 45 mm Optimum, Harmony type XVM

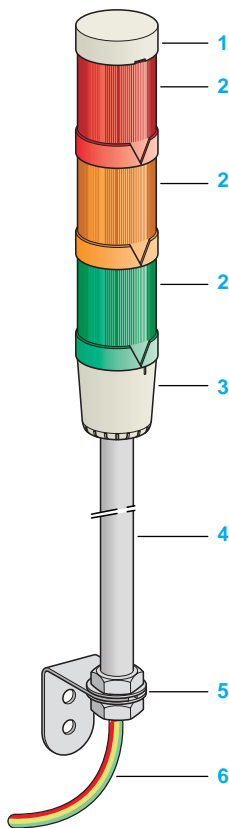

Description

Complete, pre-cabled indicator banks

The pre-assembled Ø 45 mm indicator banks XVM comprise:

- 1 A cover.
- 2 Two, three or four coloured illuminated units (red, green, orange or blue). Each illuminated unit is fitted with an incandescent bulb or an LED, depending on the model selected from the catalogue.
- 3 A base unit integrating the buzzer (depending on model).
- 4 A fixing base, height 250 mm.
- 5 A fixing bracket for mounting on a vertical support.
- 6 300 mm flying lead connections, each wire identified.

Breakdown of the reference for a complete indicator bank (1)

		XVM				1 unit				2 units				3 units				4 units			
Voltage		≈ 24 V	B																		
		≈ 120 V	G																		
		≈ 230 V	M																		
Light source		Incandescent bulb				1															
(2)		LED				2															
Illuminated unit	Colour	Red	R																		
		Orange	A																		
		Green	G																		
		Blue	B																		
		Clear	C																		
			C																		
Signalling	Steady					(3)				(3)				(3)				(3)			
	Flashing					5				5				5				5			
	"Flash"					6				6				6				6			
Buzzer		Without																			(3)
		With																			S

Reference example

XVM B2R6AGS = indicator bank for ≈ 24 V supply, with LEDs, with 1 red lens unit with "flash" discharge tube signalling, 2 lens units (1 orange and 1 green) with steady light signalling and with buzzer.

(1) This table is for information only and must not be used to create a product reference.

(2) "Flash" discharge tube to be ordered separately, see page 0/11.

(3) Not indicated, default value.

Customer assembled indicator banks

The customised composition of indicator banks XVM is obtained by assembling:

- 1 A cover and a base unit, with or without integral buzzer.
- 2 5 illuminated units maximum (1), red, orange, green, blue or clear lens units (light source not included).

Each illuminated unit can be fitted with either:

- 3 an incandescent bulb,
- 4 an LED, or
- 5 a "flash" discharge tube.

Both the LED and the "flash" discharge tube types can be fitted or removed without using a tool.

The assembly detailed above mounts on either:

- 6 an aluminium support tube (length 100, 250 or 400 mm) with a fixing bracket, or
- 7 an aluminium support tube (length 100, 250 or 400 mm) with a plastic fixing plate.

(1) Maximum configuration possibilities:

- 5 illuminated units mounted on base unit without buzzer.
- 4 illuminated units mounted on base unit fitted with buzzer.

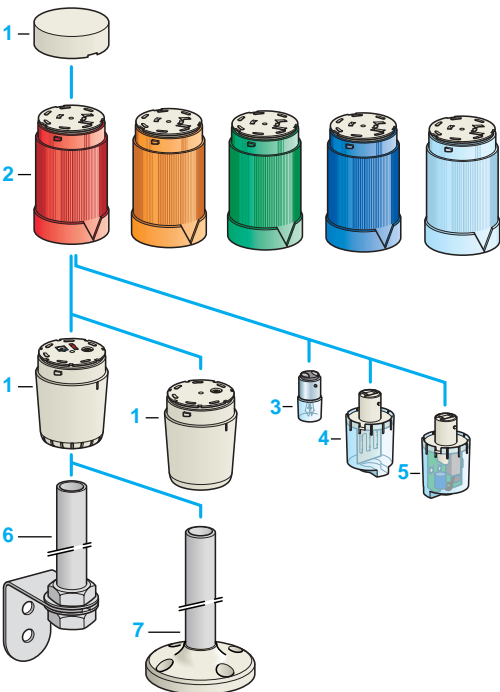

Environment characteristics

Degree of protection			IP 42 mounted vertically IP 40 in other positions
Product certifications			CCC
Approval			C€
Conformity to standards			IEC/EN 60947-1, IEC/EN 60947-5-1
Ambient air temperature	For storage	°C	- 25...+ 70
	For operation	°C	- 10...+ 50
Electric shock protection Conforming to IEC 61140, IEC 60947-1 and IEC 60947-5-1	Mounted on aluminium support tube		Class I
	Mounted on base		Class II
Protective treatment			Standard version "TC"
Electronic components protection (LED and "flash")	By integral fuse in series on the common	A	0.2 (~ 120...230 V)

Electrical characteristics

Light sources			Incandescent bulbs	LEDs		“Flash” discharge tube, 0.8 Joule
				Steady light	Flashing light	
Rated insulation voltage (Ui)	Conforming to IEC 60947-1	V	250			
Voltage limits	Conforming to IEC 60947-5-1		0.85...1.10 Un			
Light source type	For mounting in BA 15d base, 15° rotation		BA 15d base fitting			
Consumption	On ≈ 24 V	mA	Depending on bulb used	43	45	140 (on ~) 98 (on ---)
	On ~ 120 V	mA	Depending on bulb used	16	16	33
	On ~ 230 V	mA	Depending on bulb used	15	15	20
Rated impulse withstand voltage	Conforming to IEC 60947-1	kV	Uimp = 4			
Illuminating power	Average value for all colours	cds/m²	650	900	900	–
Flashing frequency	Nominal value	Hz	–	–	1	1
Audible unit (base unit fitted with buzzer)						
Consumption	On ≈ 24 V	mA	15			
	On ~ 120 V	mA	18			
	On ~ 230 V	mA	18			
Power	Continuous or intermittent tone	dB	0...80 at 1 m			
	Fundamental frequency	kHz	4 for continuous tone			
Connection of illuminated and audible units						
Terminal referencing			<input type="checkbox"/> 1 terminal referenced N : common to all 5 units, including base unit fitted with buzzer <input type="checkbox"/> 1 terminal referenced B : for base unit fitted with buzzer <input type="checkbox"/> 4 terminals referenced 1 - 2 - 3 - 4 : for 4 illuminated units mounted on base unit fitted with buzzer <input type="checkbox"/> 5 terminals referenced 1 - 2 - 3 - 4 - 5 : for 5 illuminated units mounted on base unit without buzzer			
Connection	Flying leads on pre-cabled indicator banks		Wire c.s.a.: 1 x 0.325 mm² / AWG 22 (1)			
	Screw terminals		Max.: 1 x 1.5 mm² Min.: 2 x 0.325 mm²			

(1) AWG: American Wire Gauge.

Beacons and indicator banks

Indicator banks Ø 45 mm Optimum,
Harmony type XVM
Pre-cabled indicator banks



Pre-cabled indicator banks

Description	Light source (included)	Voltage (V)	Signalling colour (1)			Reference (2)	Weight kg	
			Steady	Flashing	“Flash”			
With 2 illuminated units								
Without buzzer	Incandescent bulb, 5 W	⎓ 24	R-G	–	–	XVM B1RG	0.392	
		⎓ 120	R-G	–	–	XVM G1RG	0.392	
		⎓ 230	R-G	–	–	XVM M1RG	0.392	
	LED	⎓ 24	R-G	–	–	XVM B2RG	0.395	
		⎓ 120	R-G	–	–	XVM G2RG	0.395	
		⎓ 230	R-G	–	–	XVM M2RG	0.395	
	With buzzer integrated in base unit	Incandescent bulb, 5 W	⎓ 24	R-G	–	–	XVM B1RGS	0.402
			⎓ 120	R-G	–	–	XVM G1RGS	0.402
			⎓ 230	R-G	–	–	XVM M1RGS	0.402
LED		⎓ 24	R-G	–	–	XVM B2RGS	0.404	
		⎓ 120	R-G	–	–	XVM G2RGS	0.404	
		⎓ 230	R-G	–	–	XVM M2RGS	0.404	
With 3 illuminated units								
Without buzzer		Incandescent bulb, 5 W	⎓ 24	R-O-G	–	–	XVM B1RAG	0.493
			⎓ 120	R-O-G	–	–	XVM G1RAG	0.493
	⎓ 230		R-O-G	–	–	XVM M1RAG	0.493	
		⎓ 24	O-G	–	R	XVM B1R6AG	0.454	
		⎓ 120	O-G	–	R	XVM G1R6AG	0.454	
		⎓ 230	O-G	–	R	XVM M1R6AG	0.454	
	LED	⎓ 24	R-O-G	–	–	XVM B2RAG	0.443	
		⎓ 120	R-O-G	–	–	XVM G2RAG	0.443	
		⎓ 230	R-O-G	–	–	XVM M2RAG	0.443	
		⎓ 24	O-G	–	R	XVM B2R6AG	0.456	
		⎓ 120	O-G	–	R	XVM G2R6AG	0.456	
		⎓ 230	O-G	–	R	XVM M2R6AG	0.456	
		⎓ 24	R-G	O	–	XVM B2RA5G	0.443	
		⎓ 120	R-G	O	–	XVM G2RA5G	0.443	
		⎓ 230	R-G	O	–	XVM M2RA5G	0.443	
		⎓ 24	G	R-O	–	XVM B2R5A5G	0.443	
		⎓ 120	G	R-O	–	XVM G2R5A5G	0.443	
		⎓ 230	G	R-O	–	XVM M2R5A5G	0.443	
		⎓ 24	G	O	R	XVM B2R6A5G	0.456	
		⎓ 120	G	O	R	XVM G2R6A5G	0.456	
		⎓ 230	G	O	R	XVM M2R6A5G	0.456	

(1) Signalling colour: R: red; G: green; O: orange; B: blue.

(2) The colours are listed in same order in the references as the mounting order of the illuminated units (from top to bottom).

Beacons and indicator banks

Indicator banks Ø 45 mm Optimum,
Harmony type XVM
Pre-cabled indicator banks

Pre-cabled indicator banks (continued)

Description	Light source (included)	Voltage (V)	Signalling colour (1)			Reference (2)	Weight kg
With 3 illuminated units (continued)							
With buzzer integrated in base unit	Incandescent bulb, 5 W	≈ 24	R-O-G	–	–	XVM B1RAGS	0.449
		~ 120	R-O-G	–	–	XVM G1RAGS	0.449
		~ 230	R-O-G	–	–	XVM M1RAGS	0.449
		≈ 24	O-G	–	R	XVM B1R6AGS	0.463
		~ 120	O-G	–	R	XVM G1R6AGS	0.463
		~ 230	O-G	–	R	XVM M1R6AGS	0.463
	LED	≈ 24	R-O-G	–	–	XVM B2RAGS	0.453
		~ 120	R-O-G	–	–	XVM G2RAGS	0.453
		~ 230	R-O-G	–	–	XVM M2RAGS	0.453
		≈ 24	O-G	–	R	XVM B2R6AGS	0.466
		~ 120	O-G	–	R	XVM G2R6AGS	0.466
		~ 230	O-G	–	R	XVM M2R6AGS	0.466
		≈ 24	R-G	O	–	XVM B2RA5GS	0.453
		~ 120	R-G	O	–	XVM G2RA5GS	0.453
		~ 230	R-G	O	–	XVM M2RA5GS	0.453
		≈ 24	G	R-O	–	XVM B2R5A5GS	0.453
		~ 120	G	R-O	–	XVM G2R5A5GS	0.453
		~ 230	G	R-O	–	XVM M2R5A5GS	0.453
		≈ 24	G	O	R	XVM B2R6A5GS	0.466
		~ 120	G	O	R	XVM G2R6A5GS	0.466
		~ 230	G	O	R	XVM M2R6A5GS	0.466

With 4 illuminated units

Without buzzer	Incandescent bulb, 5 W	≈ 24	R-O-G-B	–	–	XVM B1RAGB	0.486
		~ 120	R-O-G-B	–	–	XVM G1RAGB	0.486
		~ 230	R-O-G-B	–	–	XVM M1RAGB	0.486
	LED	≈ 24	R-O-G-B	–	–	XVM B2RAGB	0.491
		~ 120	R-O-G-B	–	–	XVM G2RAGB	0.491
		~ 230	R-O-G-B	–	–	XVM M2RAGB	0.491
With buzzer integrated in base unit	Incandescent bulb, 5 W	≈ 24	R-O-G-B	–	–	XVM B1RAGBS	0.496
		~ 120	R-O-G-B	–	–	XVM G1RAGBS	0.496
		~ 230	R-O-G-B	–	–	XVM M1RAGBS	0.496
	LED	≈ 24	R-O-G-B	–	–	XVM B2RAGBS	0.501
		~ 120	R-O-G-B	–	–	XVM G2RAGBS	0.501
		~ 230	R-O-G-B	–	–	XVM M2RAGBS	0.501

(1) Signalling colour: R: red; G: green; O: orange; B: blue.

(2) The colours are listed in same order in the references as the mounting order of the illuminated units (from top to bottom).

Beacons and indicator banks

Indicator banks Ø 45 mm Optimum,
Harmony type XVM

Customer assembled indicator banks, accessories



XVM C3●



XVM C21



XVM C29●



XVM Z02



XVM Z02T



DL1 ED●S



DL2 E●●●



DL6 B●

Customer assembled indicator banks

Description	Characteristics	Voltage (V)	Colour	Reference	Weight kg
Illuminated units					
Lens units only for BA 15d base fitting bulb	Bulb not included, 5 W max.	Up to \approx 230	Green	XVM C33	0.040
			Red	XVM C34	0.040
			Orange	XVM C35	0.040
			Blue	XVM C36	0.040
			Clear	XVM C37	0.040
Base mounting units					
Base unit and cover	Base unit without buzzer	–	White	XVM C21	0.055
	Base unit with integral buzzer	\approx 24	White	XVM C29B	0.065
		\sim 120	White	XVM C29G	0.065
		\sim 230	White	XVM C29M	0.065
Base unit and cover + 250 mm support tube with fixing bracket	Base unit without buzzer	–	White	XVM C213T	0.298
	Base unit with integral buzzer	\approx 24	White	XVM C29B3T	0.308
		\sim 120	White	XVM C29G3T	0.308
		\sim 230	White	XVM C29M3T	0.308

Support tubes and fixing bases

Description	Length (mm)	Height under base unit (mm)	Colour	Reference	Weight kg
Ø 20 mm aluminium support tube with plastic fixing plate	100	78	White	XVM Z02	0.060
	250	228	White	XVM Z03	0.108
	400	378	White	XVM Z04	0.155
Ø 20 mm aluminium support tube with metal fixing bracket	100	113	–	XVM Z02T	0.198
	250	263	–	XVM Z03T	0.242
	400	413	–	XVM Z04T	0.287

Light sources for lens units (1)

Description	Signalling	Power	Sold in lots of	Voltage (V)	Colour	Unit reference	Weight kg
Incandescent bulbs	Steady light	5 W	10	≈ 24	–	DL1 EDBS	0.007
				≈ 120	–	DL1 EDGS	0.007
				≈ 230	–	DL1 EDMS	0.007
LEDs	Steady light: replace the ● by D in the references shown on the right.	–	1	≈ 24	White	DL2 E●B1	0.009
					Green	DL2 E●B3	0.009
					Red	DL2 E●B4	0.009
					Blue	DL2 E●B6	0.009
					Orange	DL2 E●B8	0.009
	Flashing light: replace the ● by K in the references shown on the right.	–	1	~ 120	White	DL2 E●G1	0.009
					Green	DL2 E●G3	0.009
					Red	DL2 E●G4	0.009
					Blue	DL2 E●G6	0.009
					Orange	DL2 E●G8	0.009
		–	1	~ 230	White	DL2 E●M1	0.009
					Green	DL2 E●M3	0.009
					Red	DL2 E●M4	0.009
					Blue	DL2 E●M6	0.009
					Orange	DL2 E●M8	0.009
Discharge tubes	"Flash"	0.8 Joule	1	≈ 24	–	DL6 BB	0.022
				~ 120	–	DL6 BG	0.022
				~ 230	–	DL6 BM	0.022

(1) All light sources are push-and-turn (15°) mounting in a BA 15d base within the illuminated units.

Accessories for pre-cabled and customer assembled indicator banks

Description	Characteristics	Reference	Weight kg
Cover only	White	XVM Z081	–
Mounting tool	Mounting and removal of incandescent bulbs type DL1	ZBZ X13	–

Beacons and indicator banks

Indicator banks Ø 45 mm Optimum,
Harmony type XVM
Pre-cabled indicator banks

Pre-cabled indicator banks

4

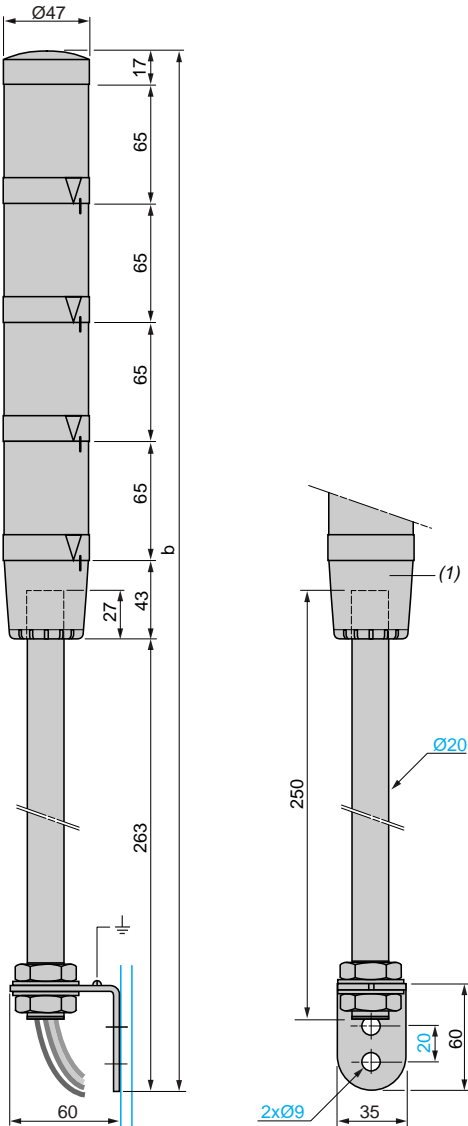

(1) Base unit with or without buzzer.

Height of pre-cabled indicator bank

Number of illuminated units	b
1 unit	392
2 units	457
3 units	522
4 units	587

Connection scheme

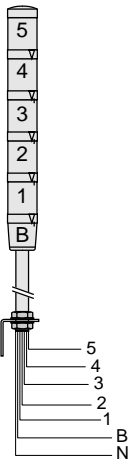

Indicator bank with buzzer (4 illuminated units max.)

- 4: 4th unit (yellow wire)
- 3: 3rd unit (green wire)
- 2: 2nd unit (white wire)
- 1: 1st unit (blue wire)
- N: common (black wire)
- B: Buzzer (grey wire)

Indicator bank without buzzer

- 5: 5th unit (red wire)
- 4: 4th unit (yellow wire)
- 3: 3rd unit (green wire)
- 2: 2nd unit (white wire)
- 1: 1st unit (blue wire)
- N: common (black wire)

Maximum capacity for wiring through support tube:

- 6 wires x 1 mm²,
- 5 wires x 1.5 mm²

Adjustment of audible signal on buzzer type unit

Base unit with integral buzzer (viewed from above)

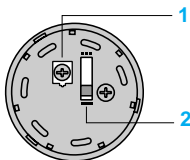

- 1 Volume adjustment potentiometer: 0 to 80 dB. Use either a cross headed or flat tipped screwdriver.
- 2 2-position selector for type of audible signal:
 - continuous tone
 - - - intermittent tone

Customer assembled indicator banks

- Cover
- Illuminated unit
- Base unit (with or without buzzer)
- Fixing base (see below)

Height of customer assembled indicator bank

Number of illuminated units (ref. 2)	b
1 unit	125
2 units	190
3 units	255
4 units	320
5 units	385

Fixing bases

XVM Z0●

XVM Z0●T

Support tube length	b1 (tube + plate)	b2 (height under base unit)
100	105	78
250	255	228
400	405	378

Support tube length	b1 (tube + bracket)	b2 (height under base unit)
100	140	113
250	290	263
400	440	413

Connection scheme

See page 4/12

Adjustment of audible signal on buzzer type unit

See page 4/12

Beacons and indicator banks

Indicator banks Ø 50 mm Universal,
Harmony type XVP C

4

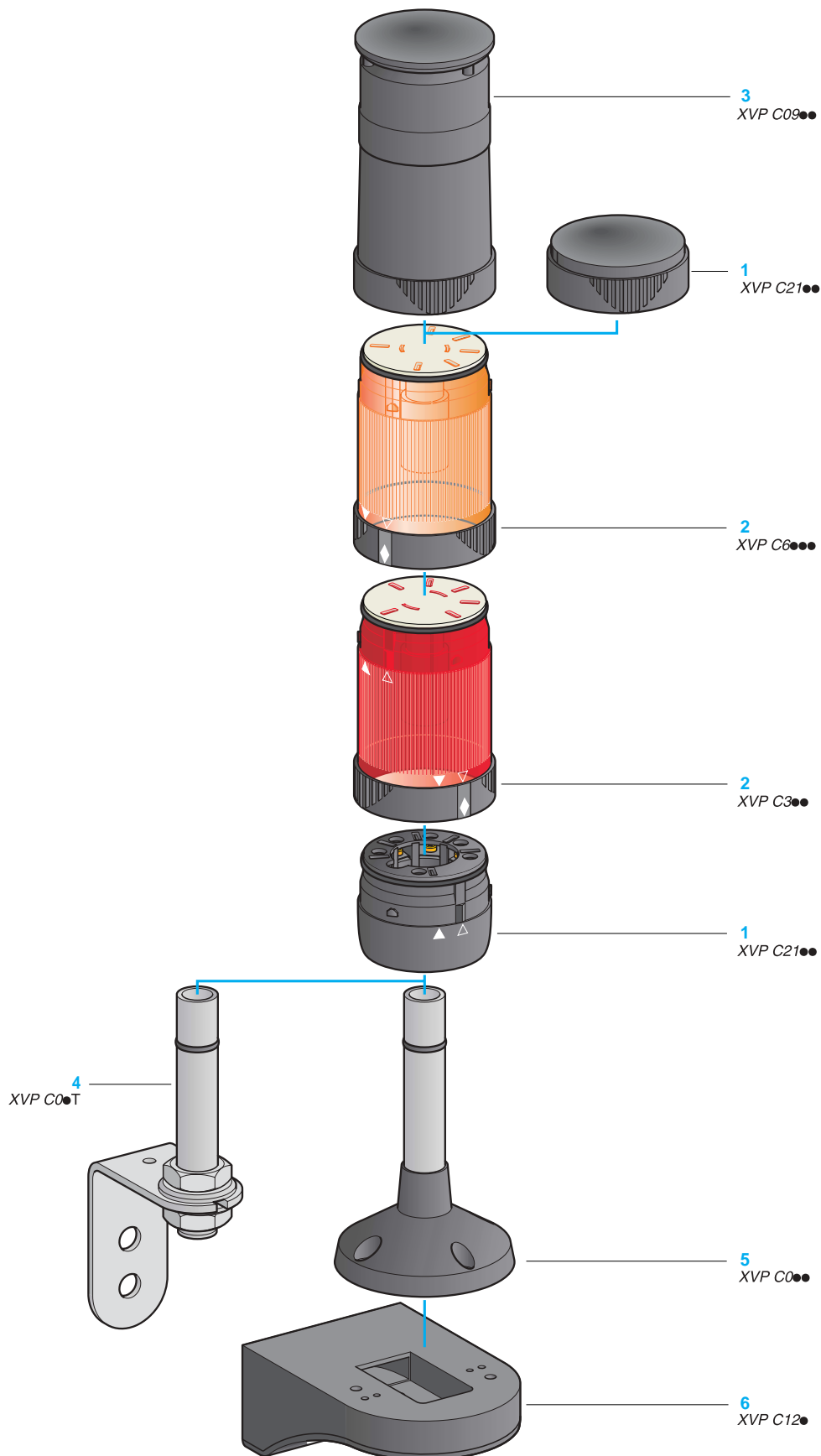

Beacons and indicator banks

Indicator banks Ø 50 mm Universal,
Harmony type XVP C

Indicator banks XVP C are visual or audible signalling units for indicating, throughout 360° and at a distance, the various states or operation sequences of a machine or installation.

Their reduced diameter (50 mm) makes them particularly suitable for use on small equipment.

In addition, the availability of two versions (aesthetic black or cream), makes them ideal for use in all sectors of activity: light industry, electronic, tertiary sector, food/drink processing.

The indicator bank

Customer assembled product

Variable composition assembly of illuminated and audible units which are supplied as separate items (assembly by user).

The bank comprises:

- 1 a base unit with bottom cable entry, a cover for the top unit,
- 2 1 to 5 illuminated units with steady, flashing or "flash" light signalling (colours: green, red, orange, blue, clear or yellow).
- 3 or 1 audible unit (always mounted at the top of the bank) + 4 illuminated units.

■ The illuminated or audible units stack vertically and are easily locked and unlocked using an integral clamping ring. Electrical connections between each unit are made automatically.

■ For indicator banks XVP C, several illuminated "flash" units can be mounted.

■ The flashing illuminated units are only available in the LED version and incorporate BA 15d base mounted flashing LEDs.

Accessories

- 4 Threaded aluminium support tube with fixing bracket, for heights beneath the base unit of 77, 227 or 377 mm.
- 5 Aluminium support tube with integral black or cream fixing base, for heights beneath the base unit of 89, 237 or 387 mm, for direct mounting on the machine or on a vertical support 6.

Installation

Mounting

- Base unit fixed directly onto panel, or
- using support tube with integral fixing base, or
- using threaded support tube with metal fixing bracket, or
- using support tube with integral fixing base, mounted on a fixing plate for use on a vertical support.

Cabling

By means of terminal block incorporated in base unit. The screw and captive cable clamp terminals are protected to prevent any accidental contact with live parts. Cream coloured base units are available for use with eyelet tags.

Environment characteristics

Product certifications Standard version			CSA, C€ marking
Conformity to standards			IEC/EN 60947-5-1
Protective treatment Standard version			"TC"
Ambient air temperature	For storage	°C	- 40...+ 70
	For operation	°C	- 25...+ 50 with 7 W incandescent bulb - 25...+ 50 with LED
	Illuminated units with steady light signalling Illuminated "flash" units (discharge tube) Audible units	°C	- 25...+ 50
Electric shock protection conforming to IEC 536	Mounted on support tube		Class I
	Mounted on base unit		Class II
Degree of protection Conforming to IEC 60529 and NF C 20-010			- IP 65 for illuminated units - IP 43 for audible units
Material	Illuminated units		Polycarbonate and Polyamide
	Base unit and cover		Acrylic Butadiene-Styrene + Polycarbonate and Polyamide
	Support tube + fixing plate		Aluminium and Acrylic Butadiene-Styrene + Polycarbonate

Electrical characteristics

Rated insulation voltage (Ui)	Conforming to IEC 60947-1	V	250
Voltage limits	Conforming to IEC 60947-5-1	V	0.85 to 1.10 Un (Un: nominal voltage)
Consumption	LED unit	Steady light signalling	mA \approx 24 V: < 80 \sim 120...230 V: < 30
		Flashing light signalling	mA \approx 24 V: < 40 \sim 120...230 V: < 15
	Illuminated "flash" unit (discharge tube)	On power-up	mA \approx 24 V: \leq 40
			mA \sim 120 V: \leq 20
			mA \sim 230 V: \leq 11
	Audible units		mA \approx 24 V: \leq 15
			mA \sim 120 V: \leq 15
			mA \sim 230 V: \leq 12
Rated impulse withstand voltage	Conforming to IEC 60947-1	kV	U imp = 4
Light source	Illuminated units with steady or flashing light signalling		LEDs: degree of pollution 2
			Incandescent bulbs with BA 15d base fitting, maximum power 7 W
Illuminating power	Illuminated units with steady light signalling	cds	2.4 with clear lens unit (7 W incandescent bulb)
	Illuminated "flash" units (discharge tube)	cds	1.2 (24 V) with clear lens unit (0.3 J tube), 5 (120...230 V) with clear lens unit (0.6 J tube)
Audible unit	Continuous or intermittent tone	dB	Adjustable: 85 \pm 3 max., 55 \pm 3 min. at 1 m
	Fundamental frequency	kHz	10 adjustable levels
Terminal referencing	Common to all 5 units		1 terminal referenced -/C
	Depending on number of units		1 or 5 terminals referenced +/1 to +/5
Connection	Maximum clamping capacity on protected, ready-to-tighten, screw and captive cable clamp terminals	mm²	1 x 1.5 with cable end
Frequency of illuminated units	Illuminated "flash" units (discharge tube)	Hz	0.6...2
	Flashing illuminated units	Hz	1
Service life in rapidly ageing environment	Illuminated "flash" units (discharge tube) Audible units	H	> 1000, continuous (climatic cycle - 25 °C...+ 50 °C)

Beacons and indicator banks

Indicator banks Ø 50 mm Universal,
Harmony type XVP C (for customer assembly, up to 5 units)
Illuminated units

530419



XVP C3●

530420



XVP C3●W

Illuminated units with steady or flashing light signalling for BA 15d bulb or LED

Description	Light source, to be ordered separately	Colour	Reference	Weight kg
With black clamping ring	Incandescent bulb 7 W max. 250 V max. or LED	Green	XVP C33	0.100
		Red	XVP C34	0.100
		Orange	XVP C35	0.100
		Blue	XVP C36	0.100
		Clear	XVP C37	0.100
		Yellow	XVP C38	0.100
With cream clamping ring	Incandescent bulb 7 W max. 250 V max. or LED	Green	XVP C33W	0.100
		Red	XVP C34W	0.100
		Orange	XVP C35W	0.100
		Blue	XVP C36W	0.100
		Clear	XVP C37W	0.100
		Yellow	XVP C38W	0.100

BA 15d bulbs and LEDs

Description	Characteristics		Sold in lots of	Unit reference	Weight kg	
Incandescent bulbs BA 15d base fitting	24 V	4 W	10	DL1 BEBS	0.090	
	120 V	5 W	10	DL1 BEGS	0.090	
	230 V	5 W	10	DL1 BEMS	0.090	
	12 V	7 W	10	DL1 BEJ	0.090	
	24 V	6.5 W	10	DL1 BEB	0.090	
	48 V	6 W	10	DL1 BEE	0.090	
	120 V	7 W	10	DL1 BEG	0.090	
	230 V	7 W	10	DL1 BEM	0.090	
LEDs BA 15d base fitting 	≈ 24 V	White	1	DL1 BDB1	0.015	
		Green	1	DL1 BDB3	0.015	
		Red	1	DL1 BDB4	0.015	
		Orange	1	DL1 BDB5	0.015	
		Blue	1	DL1 BDB6	0.015	
		Yellow	1	DL1 BDB8	0.015	
	~ 120 V	White	1	DL1 BDG1	0.015	
		Green	1	DL1 BDG3	0.015	
		Red	1	DL1 BDG4	0.015	
		Orange	1	DL1 BDG5	0.015	
		Blue	1	DL1 BDG6	0.015	
		Yellow	1	DL1 BDG8	0.015	
	~ 230 V	White	1	DL1 BDM1	0.015	
		Green	1	DL1 BDM3	0.015	
		Red	1	DL1 BDM4	0.015	
		Orange	1	DL1 BDM5	0.015	
		Blue	1	DL1 BDM6	0.015	
		Yellow	1	DL1 BDM8	0.015	
	Flashing LEDs BA 15d base fitting 	≈ 24 V	White	1	DL1 BKB1	0.015
			Green	1	DL1 BKB3	0.015
			Red	1	DL1 BKB4	0.015
			Orange	1	DL1 BKB5	0.015
			Blue	1	DL1 BKB6	0.015
			Yellow	1	DL1 BKB8	0.015
~ 120 V		White	1	DL1 BKG1	0.015	
		Green	1	DL1 BKG3	0.015	
		Red	1	DL1 BKG4	0.015	
		Orange	1	DL1 BKG5	0.015	
		Blue	1	DL1 BKG6	0.015	
		Yellow	1	DL1 BKG8	0.015	
~ 230 V		White	1	DL1 BKM1	0.015	
		Green	1	DL1 BKM3	0.015	
		Red	1	DL1 BKM4	0.015	
		Orange	1	DL1 BKM5	0.015	
		Blue	1	DL1 BKM6	0.015	
		Yellow	1	DL1 BKM8	0.015	

Protected[®]
LEDProtected[®]
LED

Beacons and indicator banks

Indicator banks Ø 50 mm Universal,
Harmony type XVP C (for customer assembly, up to 5 units)
Illuminated and audible units



XVP C6●●



XVP C6●●W

Illuminated “flash” units with discharge tube

Description	Voltage	Colour	Reference	Weight kg
With black clamping ring	“Flash” discharge tube (0.3 Joules) --- 24 V	Green	XVP C6B3	0.120
		Red	XVP C6B4	0.120
		Orange	XVP C6B5	0.120
		Blue	XVP C6B6	0.120
		Clear	XVP C6B7	0.120
		Yellow	XVP C6B8	0.120
	“Flash” discharge tube (0.6 Joules) ~ 120 V	Green	XVP C6G3	0.115
		Red	XVP C6G4	0.115
		Orange	XVP C6G5	0.115
		Blue	XVP C6G6	0.115
		Clear	XVP C6G7	0.115
		Yellow	XVP C6G8	0.115
	“Flash” discharge tube (0.6 Joules) ~ 230 V	Green	XVP C6M3	0.115
		Red	XVP C6M4	0.115
		Orange	XVP C6M5	0.115
		Blue	XVP C6M6	0.115
		Clear	XVP C6M7	0.115
		Yellow	XVP C6M8	0.115
With cream clamping ring	“Flash” discharge tube (0.3 Joules) --- 24 V	Green	XVP C6B3W	0.120
		Red	XVP C6B4W	0.120
		Orange	XVP C6B5W	0.120
		Blue	XVP C6B6W	0.120
		Clear	XVP C6B7W	0.120
		Yellow	XVP C6B8W	0.120
	“Flash” discharge tube (0.6 Joules) ~ 120 V	Green	XVP C6G3W	0.115
		Red	XVP C6G4W	0.115
		Orange	XVP C6G5W	0.115
		Blue	XVP C6G6W	0.115
		Clear	XVP C6G7W	0.115
		Yellow	XVP C6G8W	0.115
	“Flash” discharge tube (0.6 Joules) ~ 230 V	Green	XVP C6M3W	0.115
		Red	XVP C6M4W	0.115
		Orange	XVP C6M5W	0.115
		Blue	XVP C6M6W	0.115
		Clear	XVP C6M7W	0.115
		Yellow	XVP C6M8W	0.115



XVP C09●



XVP C09●W

Audible units

Description	Voltage	Colour	Reference	Weight kg
Buzzer, adjustable 55...85 dB at 1 m	--- 24 V	Black	XVP C09B	0.153
	~ 120 V	Black	XVP C09G	0.153
	~ 230 V	Black	XVP C09M	0.153
	--- 24 V	Cream	XVP C09BW	0.153
	~ 120 V	Cream	XVP C09GW	0.153
	~ 230 V	Cream	XVP C09MW	0.153

Beacons and indicator banks

Indicator banks Ø 50 mm Universal,
Harmony type XVP C
Base units, covers and accessories



Base units

Base units for direct or tube fixing

Description	Colour	Reference	Weight kg
Base unit + cover for bared wires or wires with cable end	Black	XVP C21	0.125
	Cream	XVP C21W	0.125
Base unit + cover for eyelet tags	Cream	XVP C21WR	0.125

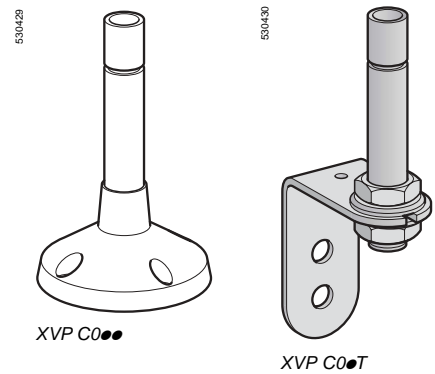

Accessories

Description	Characteristics	Reference	Weight kg
Aluminium support tube with integral black fixing base	112 mm	XVP C02	0.112
	260 mm	XVP C03	0.173
	410 mm	XVP C04	0.253
Aluminium support tube with integral cream fixing base	112 mm	XVP C02W	0.112
	260 mm	XVP C03W	0.173
	410 mm	XVP C04W	0.253
Threaded aluminium support tube + stainless steel fixing bracket	100 mm	XVP C02T	0.245
	250 mm	XVP C03T	0.306
	400 mm	XVP C04T	0.386
Fixing plate for use on vertical support, black	For mounting XVP C0●● support tubes with integral fixing base	XVP C12	0.083
Fixing plate for use on vertical support, cream	For mounting XVP C0●● support tubes with integral fixing base	XVP C12W	0.083
Bulb mounting and removal tool	–	XVP CX13	0.015

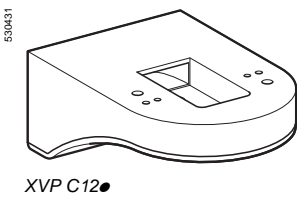

Beacons and indicator banks

Indicator banks Ø 50 mm Universal,
Harmony type XVP C

Indicator banks XVP C●●●

Without audible unit

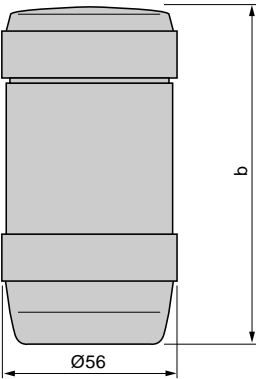

Number of illuminated units	b
1	108
2	170
3	232
4	294
5	356

With audible unit

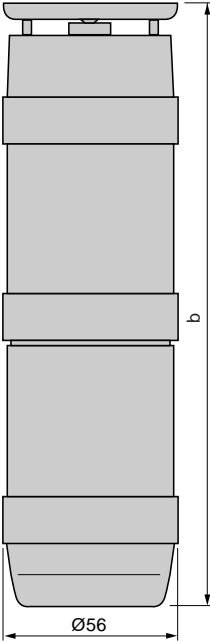

Number of units:		b
Illuminated	+ Audible	
0	+ 1	129
1	+ 1	194
2	+ 1	256
3	+ 1	318
4	+ 1	380

Panel cut-out for direct fixing (on base unit XVP C21●●)

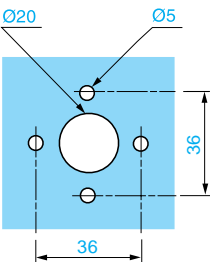

Installation

Connections

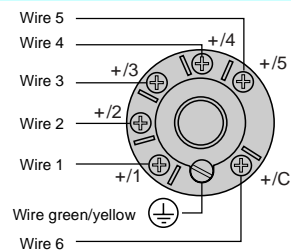

Adjustment of audible signal for buzzers type XVP C09●

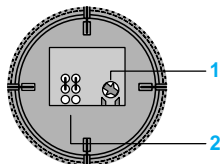

- 1 Volume adjustment potentiometer: 55...85 dB. Use either a cross headed or flat tipped screwdriver.
- 2 Adjustment of type of audible signal according to position of 2 links. Use flat-nose pliers.
- 3 10 configurations are possible, see table below. Factory set on position 5: continuous tone.

3	Position of links	Type of audible signal	Position of links	Type of audible signal
1	5 ○ 6 1 ○ 2		6	
2	5 ○ 6 1 ○ 2		7	
3	5 ○ 6 1 ○ 2		8	
4	5 ○ 6 1 ○ 2		9	
5	5 ○ 6 1 ○ 2		10	

Support tube XVP C0●● with integral
fixing base

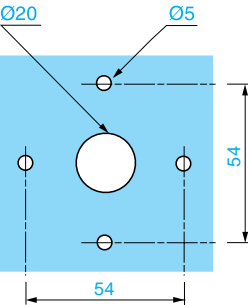
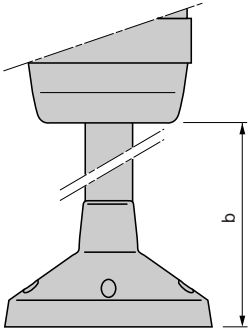

Height under base unit	b
XVP C02●	89
XVP C03●	237
XVP C04●	387

Threaded support tube XVP C0●T with metal fixing bracket

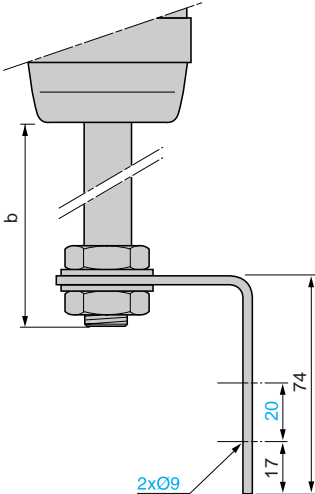

Height under base unit	b
XVP C02T	77
XVP C03T	227
XVP C04T	377

Mounting using fixing plate XVP C12● for use on a vertical support

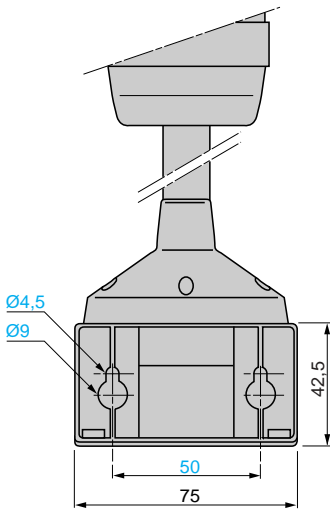
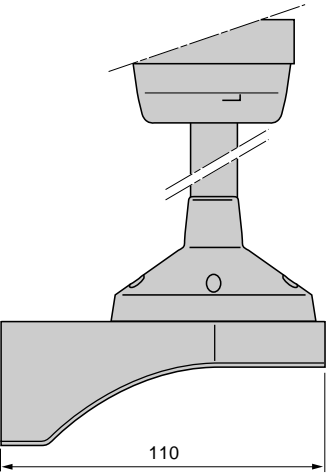

Note: support tube XVP C0●● with integral fixing base must be used.

Beacons and indicator banks

Beacons and indicator banks Ø 70 mm Optimum, Harmony type XVE

4

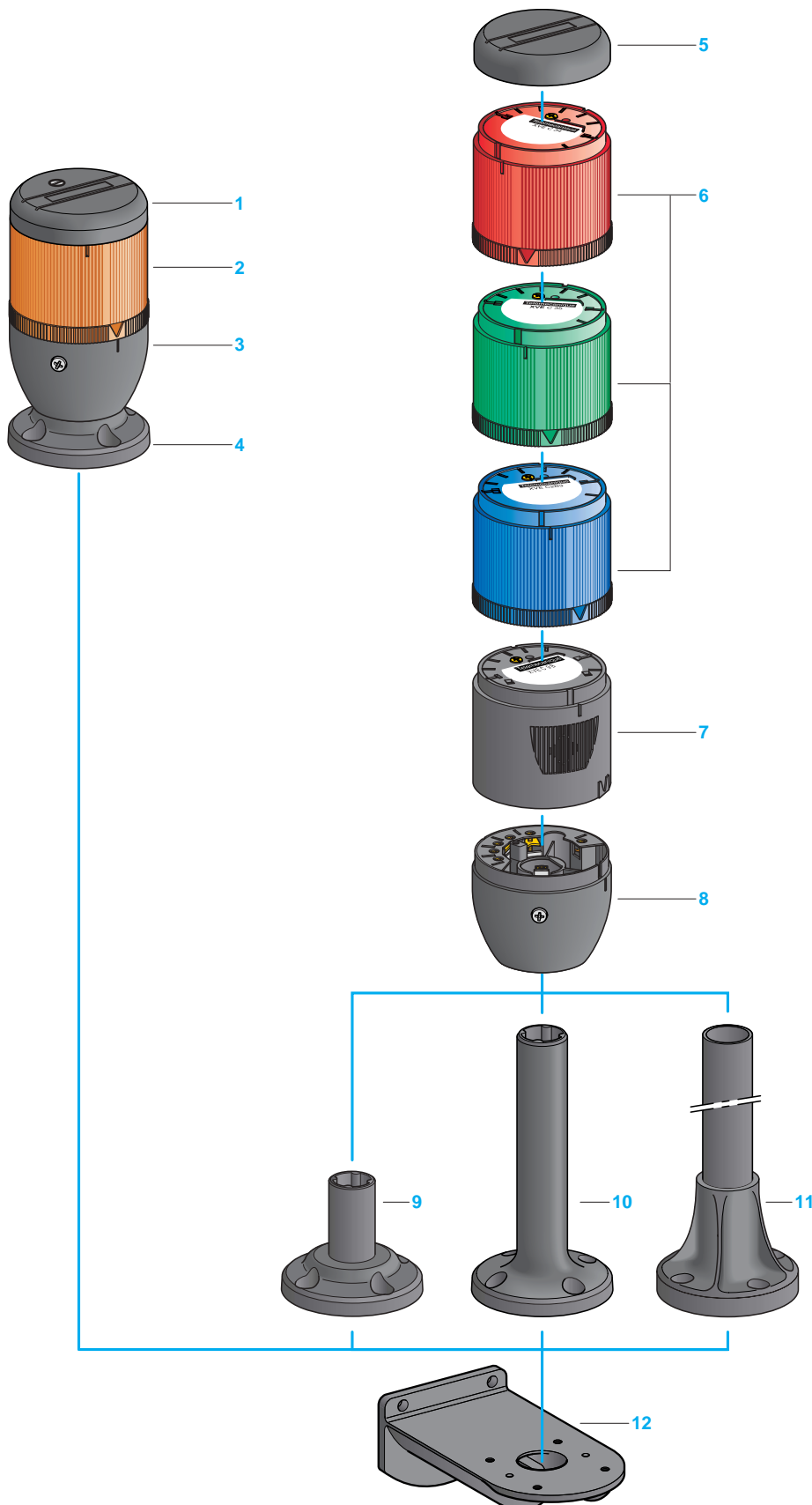

Description

Illuminated beacon

The illuminated beacon is a complete product comprising:

- 1 A screw fixing cover.
- 2 One coloured illuminated unit (green, red, orange, blue or clear).
- 3 A base unit with terminal block and bottom cable entry.
- 4 A monobloc fixing base for mounting on machine.

Indicator bank

The indicator bank is a customer assembled product using:

- 5 A cover.
- 6 1 to 5 coloured illuminated units (green, red, orange, blue or clear) with a choice of 3 types of signalling (steady, flashing or "flash").
- 7 1 audible unit.
- 8 A base unit (IP 42 or IP 54) with terminal block and bottom cable entry.
- 9 A plastic fixing base, 20 mm high.
- 10 A plastic fixing base, 100 mm high.
- 11 An aluminium support tube glued into a plastic fixing plate, for heights beneath the base unit of 80, 380 or 780 mm.

To be ordered separately:

- 12 Fixing plate for mounting on vertical support.

Beacons and indicator banks

Beacons and indicator banks Ø 70 mm Optimum, Harmony type XVE

Presentation

The beacons and indicator banks of the XVE range are designed for remote signalling of the status of a machine, equipment or specific application, either visually using illuminated units which are visible throughout 360° or audibly using an 85 dB buzzer.

The XVE Optimum range provides efficient signalling (5 colours available), at medium range distances (30 m), in both indoor and outdoor environments.

The standard configuration of the beacons and indicator banks is an IP 42 degree of protection, which is sufficient for the majority of indoor applications.

Both the IP 42 pre-configured beacons and indicator banks can be upgraded to IP 54 by using a sealing kit (1).

Depending on the indicator bank base unit selected, it is possible to achieve an IP 54 degree of protection for outdoor usage (1).

Composition

■ The beacons are supplied complete and incorporate a single steady or "flash" light illuminated unit and a short fixing base. They are ready to use.

■ The indicator banks must be assembled by the user and comprise signalling units, mounted on a base unit, and a fixing base. These various items are to be selected from the catalogue.

□ For an indicator bank, a maximum of 5 illuminated units or 4 illuminated units + 1 audible unit can be assembled.

□ The illuminated or audible units stack vertically and are easily fitted together. A screw secures their mounting. Electrical connections between each unit are made automatically as the units are mechanically assembled.

□ All the signalling units are identical in size and their positioning is unrestricted.

Signalling functions

Steady light signalling

Two types of light source are available for steady light signalling:

□ The incandescent BA 15d base fitting bulb, 5 W max. power, is recommended for infrequent usage and where no vibration or mechanical shock exists. The bulb is not included with the lens unit and must be fitted separately.

□ LEDs are recommended for continuous usage: 100,000 operating hours without maintenance and low consumption. They have a good resistance to vibration. Using an LED of a colour best suited to the colour of the lens unit provides optimal luminosity.

Flashing light signalling

Flashing light signalling is also obtained using the LED. It meets requirements regarding reliability, continuous usage and electronic simplicity.

A flashing function can also be obtained from a steady light LED illuminated unit by using a PLC output signal.

"Flash" light signalling

The light source is a 1 Joule discharge tube which delivers a powerful warning signal. It is available for the 5 colours.

Audible signalling

Audible signalling is provided by a continuous tone buzzer with a power rating of 85 dB at 1 m.

Installation

Mounting

Fixed onto support panel using plastic monobloc fixing base or fixing base comprising an aluminium support tube glued into a plastic fixing plate.

Cabling

By means of terminal block incorporated in base unit. The terminals are protected and of the screw and captive cable clamp type.

(1) See page 4/27.

Environment characteristics

Degree of protection	Conforming to IEC 60529		<ul style="list-style-type: none"> ■ IP 42 in vertical position, IP 40 for other positions ■ IP 54 for reinforced protection version: <ul style="list-style-type: none"> □ for all mounting positions using fixing base XVE Z13, □ only in vertical position for other heights of fixing base
Product certifications			UL, CSA, CCC
Approval			C€
Conformity to standards			IEC/EN 60947-1, IEC/EN 60947-5-1
Ambient air temperature	For storage	°C	- 40...+ 70
	For operation	°C	- 25...+ 55
Electric shock protection	Mounted on plastic support tube		Class I
Conforming to IEC 61140	Mounted on aluminium support tube		Class I
Protective treatment			Standard version: "TC"
Electronic components protection (LED and flash)	By integral fuse in series on the common	A	0.63 (\approx 24 V)
		A	0.16 (\sim 120...240 V)

Electrical characteristics

Illuminated units			With bulb, not included (lens unit only)	With integral LED, steady light signalling	With integral LED, flashing light signalling	With “flash” discharge tube, 1 Joule
Rated insulation voltage (Ui)	Conforming to IEC 60947-1	V	250	250	250	250
Voltage limits	Conforming to IEC 60947-5-1	V	0.85...1.10 Un (Un: nominal voltage)			
Light source			BA 15d base fitting bulb, maximum power 5 W (240 V max.)	LED	LED	“Flash” discharge tube, 1 Joule
Consumption	On \approx 24 V	mA	Depending on bulb used	< 25	< 30	< 145 on \sim 24 V < 85 on \approx 24 V
	On \sim 120 V	mA	Depending on bulb used	< 25	< 25	< 35
	On \sim 230/240 V	mA	Depending on bulb used	< 25	< 25	< 25
Rated impulse withstand voltage	Conforming to IEC 60947-1	kV	U imp = 4			
Illuminating power	Average value for all colours	cds/m²	640	800	800	–
Flashing frequency	Nominal value	Hz	–	–	1	1
Audible units						
Consumption	On \approx 24 V	mA	< 15			
	On \sim 120 V	mA	< 25			
	On \sim 230/240 V	mA	< 25			
Power	Continuous tone	dB	85 at 1 m			
	Fundamental frequency	kHz	2.6 for continuous tone			
Connection of illuminated and audible units						
Terminal referencing			1 terminal referenced “C” common to all 5 units 5 terminals referenced 1 to 5			
Connection	Maximum clamping capacity on protected, ready-to-tighten, screw and captive cable clamp terminals	mm²	1 x 1.5 with cable end			

Beacons and indicator banks

Beacons and indicator banks Ø 70 mm Optimum,
Harmony type XVE
Illuminated beacons



XVE L3●●



XVE L2●●



XVE L6●●

Illuminated beacons with steady light signalling

Description	Light source	Supply voltage	Colour of lens unit	Reference	Weight kg
Complete unit comprising: - 1 screw fixing cover, - 1 illuminated unit, - 1 base unit, - 1 short fixing base	Bulb, not included, 5 W max.	≈ 240 V max.	Green	XVE L33	0.245
			Red	XVE L34	0.245
			Orange	XVE L35	0.245
			Blue	XVE L36	0.245
			Clear	XVE L37	0.245
	Illuminated unit with integral LED	≈ 24 V	Green	XVE L2B3	0.250
			Red	XVE L2B4	0.250
			Orange	XVE L2B5	0.250
			Blue	XVE L2B6	0.250
			Clear	XVE L2B7	0.250
		~ 120 V	Green	XVE L2G3	0.250
			Red	XVE L2G4	0.250
			Orange	XVE L2G5	0.250
			Blue	XVE L2G6	0.250
			Clear	XVE L2G7	0.250
		~ 230 V/240 V	Green	XVE L2M3	0.250
			Red	XVE L2M4	0.250
			Orange	XVE L2M5	0.250
			Blue	XVE L2M6	0.250
			Clear	XVE L2M7	0.250

Illuminated beacons with “flash” light signalling

Description	Light source	Supply voltage	Colour of lens unit	Reference	Weight kg
Complete unit comprising: - 1 screw fixing cover, - 1 illuminated unit, - 1 base unit, - 1 short fixing base	Illuminated unit with 1 Joule “flash” discharge tube	≈ 24 V	Green	XVE L6B3	0.270
			Red	XVE L6B4	0.270
			Orange	XVE L6B5	0.270
			Blue	XVE L6B6	0.270
			Clear	XVE L6B7	0.270
		~ 120 V	Green	XVE L6G3	0.270
			Red	XVE L6G4	0.270
			Orange	XVE L6G5	0.270
			Blue	XVE L6G6	0.270
			Clear	XVE L6G7	0.270
		~ 230 V/240 V	Green	XVE L6M3	0.270
			Red	XVE L6M4	0.270
			Orange	XVE L6M5	0.270
			Blue	XVE L6M6	0.270
			Clear	XVE L6M7	0.270

Beacons and indicator banks

Beacons and indicator banks Ø 70 mm Optimum,
Harmony type XVE
Indicator banks for customer assembly

Illuminated units with steady light signalling

Description	Light source	Supply voltage	Colour of lens unit	Reference	Weight kg
Lens units only for BA 15d base fitting bulb	Bulb, not included, 5 W max.	≈ 240 V max.	Green	XVE C33	0.072
			Red	XVE C34	0.072
			Orange	XVE C35	0.072
			Blue	XVE C36	0.072
			Clear	XVE C37	0.072
Illuminated units	Integral LED	≈ 24 V	Green	XVE C2B3	0.077
			Red	XVE C2B4	0.077
			Orange	XVE C2B5	0.077
			Blue	XVE C2B6	0.077
			Clear	XVE C2B7	0.077
		~ 120 V	Green	XVE C2G3	0.077
			Red	XVE C2G4	0.077
			Orange	XVE C2G5	0.077
			Blue	XVE C2G6	0.077
			Clear	XVE C2G7	0.077
		~ 230 V/240 V	Green	XVE C2M3	0.077
			Red	XVE C2M4	0.077
			Orange	XVE C2M5	0.077
			Blue	XVE C2M6	0.077
			Clear	XVE C2M7	0.077



XVE C3●



XVE C2●●●

Illuminated units with flashing light signalling

Illuminated units	Integral LED	≈ 24 V	Green	XVE C5B3	0.077
			Red	XVE C5B4	0.077
			Orange	XVE C5B5	0.077
			Blue	XVE C5B6	0.077
			Clear	XVE C5B7	0.077
		~ 120 V	Green	XVE C5G3	0.077
			Red	XVE C5G4	0.077
			Orange	XVE C5G5	0.077
			Blue	XVE C5G6	0.077
			Clear	XVE C5G7	0.077
		~ 230 V/240 V	Green	XVE C5M3	0.077
			Red	XVE C5M4	0.077
			Orange	XVE C5M5	0.077
			Blue	XVE C5M6	0.077
			Clear	XVE C5M7	0.077



XVE C5●●●

Illuminated units with “flash” light signalling

Illuminated units	“Flash” discharge tube, 1 Joule	≈ 24 V	Green	XVE C6B3	0.094
			Red	XVE C6B4	0.094
			Orange	XVE C6B5	0.094
			Blue	XVE C6B6	0.094
			Clear	XVE C6B7	0.094
		~ 120 V	Green	XVE C6G3	0.094
			Red	XVE C6G4	0.094
			Orange	XVE C6G5	0.094
			Blue	XVE C6G6	0.094
			Clear	XVE C6G7	0.094
		~ 230 V/240 V	Green	XVE C6M3	0.094
			Red	XVE C6M4	0.094
			Orange	XVE C6M5	0.094
			Blue	XVE C6M6	0.094
			Clear	XVE C6M7	0.094



XVE C6●●●

Audible units

Description	Power	Supply voltage	Reference	Weight kg
Buzzer, single tone	85 dB at 1 metre	≈ 24 V	XVE C9B	0.090
		~ 120 V	XVE C9G	0.090
		~ 230 V/240 V	XVE C9M	0.090



XVE C9●

Beacons and indicator banks

Beacons and indicator banks Ø 70 mm Optimum,
Harmony type XVE

Indicator banks for customer assembly (continued)

Separate components for beacons and indicator banks



XVE C21



XVE C21P



XVE Z13

XVB C02



XVB Z02

XVB Z03/Z04



XVB Z01

XVB C12



XVE Z081



XVE Z082



XVE Z083



DL1 BE●S

Base units and covers

Indicator bank usage	Composition	Reference	Weight kg
Indoors (IP 42)	Base unit and cover	XVE C21	0.110
Outdoors (IP 54)	Base unit with seal + screw fixing cover + kit comprising 5 seals for lens units and buzzer + 1 seal for fixing base XVE Z13	XVE C21P	0.120

Fixing components

Description	Height under base unit mm	Colour	Reference	Weight kg
Plastic fixing bases	20	Black	XVE Z13	0.040
	100	Black	XVD C02	0.056
Fixing bases comprising: Ø 25 mm aluminium support tube glued into black plastic fixing plate	80	Black aluminium	XVB Z02	0.110
		Aluminium	XVB Z02A	0.110
	380	Black aluminium	XVB Z03	0.200
		Aluminium	XVB Z03A	0.200
	780	Black aluminium	XVB Z04	0.325
		Aluminium	XVB Z04A	0.325

Description	For	Material	Reference	Weight kg
Fixing plate	Ø 25 mm aluminium support tube (to be glued into fixing plate)	Plastic	XVB Z01	0.050
Fixing plate for use on vertical support	Mounting beacons and indicator banks (requires a fixing base)	Zamak	XVB C12	0.380

Separate components for beacons and indicator banks

Description	For use with	Composition	Reference	Weight kg
Cover	Beacons and indicator banks	—	XVE Z081	0.010
IP 54 sealing kit	Indicator banks	5 toric seals for lens units + base unit seal + 1 fixing plate seal + 1 seal for fixing base XVE Z13 + screw fixing cover	XVE Z082	0.015
	Beacons	1 lens unit seal + 1 base unit seal + 2 fixing base seals	XVE Z083	0.005

Description	Electrical characteristics	Sold in lots of	Reference	Weight kg
Incandescent bulbs with BA 15d base fitting for lens units type XVE L3● and XVE C3●	5 W ≈ 24 V	10	DL1 BEBS	0.100
	5 W ≈ 120 V	10	DL1 BEGS	0.100
	5 W ≈ 230 V	10	DL1 BEMS	0.100

Beacons and indicator banks

Beacons and indicator banks Ø 70 mm Optimum,
Harmony type XVE
Illuminated beacons

Illuminated beacons XVE L●●●

Panel cut-out for mounting directly on fixing base

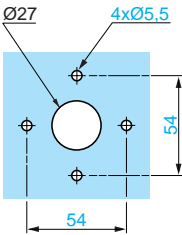
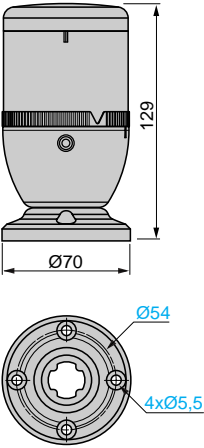

4

Mounting on fixing plate XVB C12

Vertical support panel drillings for
mounting fixing plate XVB C12

Wiring scheme

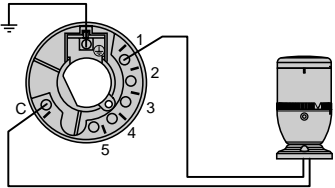
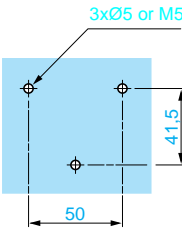
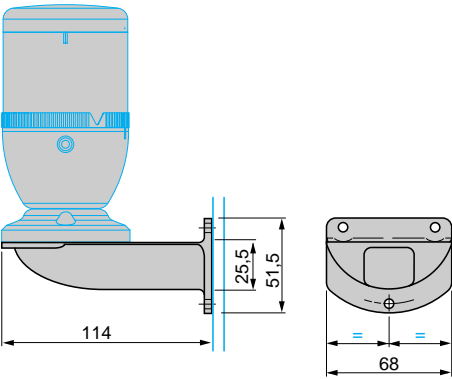

Beacons and indicator banks

Beacons and indicator banks, Ø 70 mm Optimum,
Harmony type XVE
Indicator banks

Indicator banks XVE C●●●

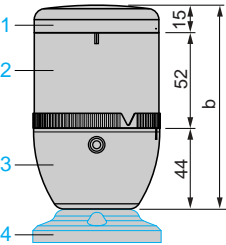

- 1 Cover XVE Z081 or cover XVE C21/C21P (with base unit),
- 2 Illuminated units XVE C●● and/or audible unit XVE C9●,
- 3 Base unit XVE C21/C21P,
- 4 Fixing bases (see below).

Height of indicator bank	
Number of units (ref. 2)	b
1 unit	111
2 units	163
3 units	215
4 units	267
5 units	319

Fixing bases (height under base unit)

XVE Z13

XVD C02

XVB Z0●●

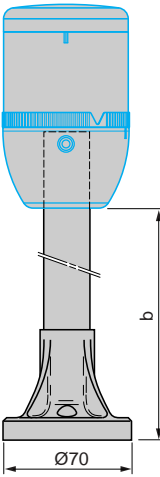
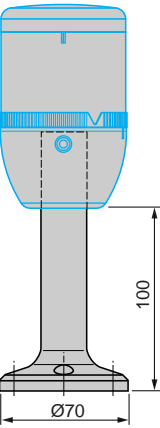
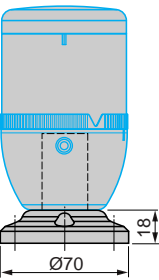

Height under base unit	
Fixing base	b
XVB Z02/Z02A	80
XVB Z03/Z03A	380
XVB Z04/Z04A	780

Panel cut-out for mounting directly on fixing base

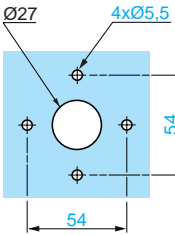

Mounting on fixing plate XVB C12

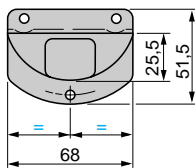
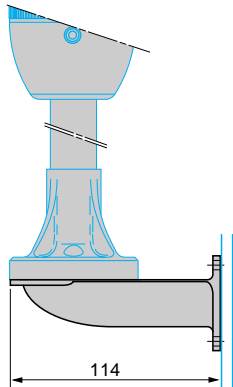

Vertical support panel drillings for mounting fixing plate XVB C12

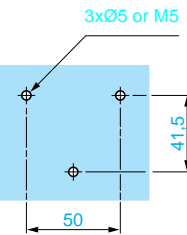

Wiring scheme

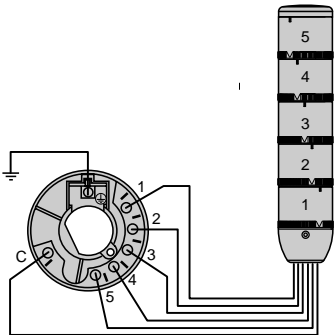

Beacons and indicator banks

Beacons and indicator banks Ø 70 mm Universal, Harmony type XVB

4

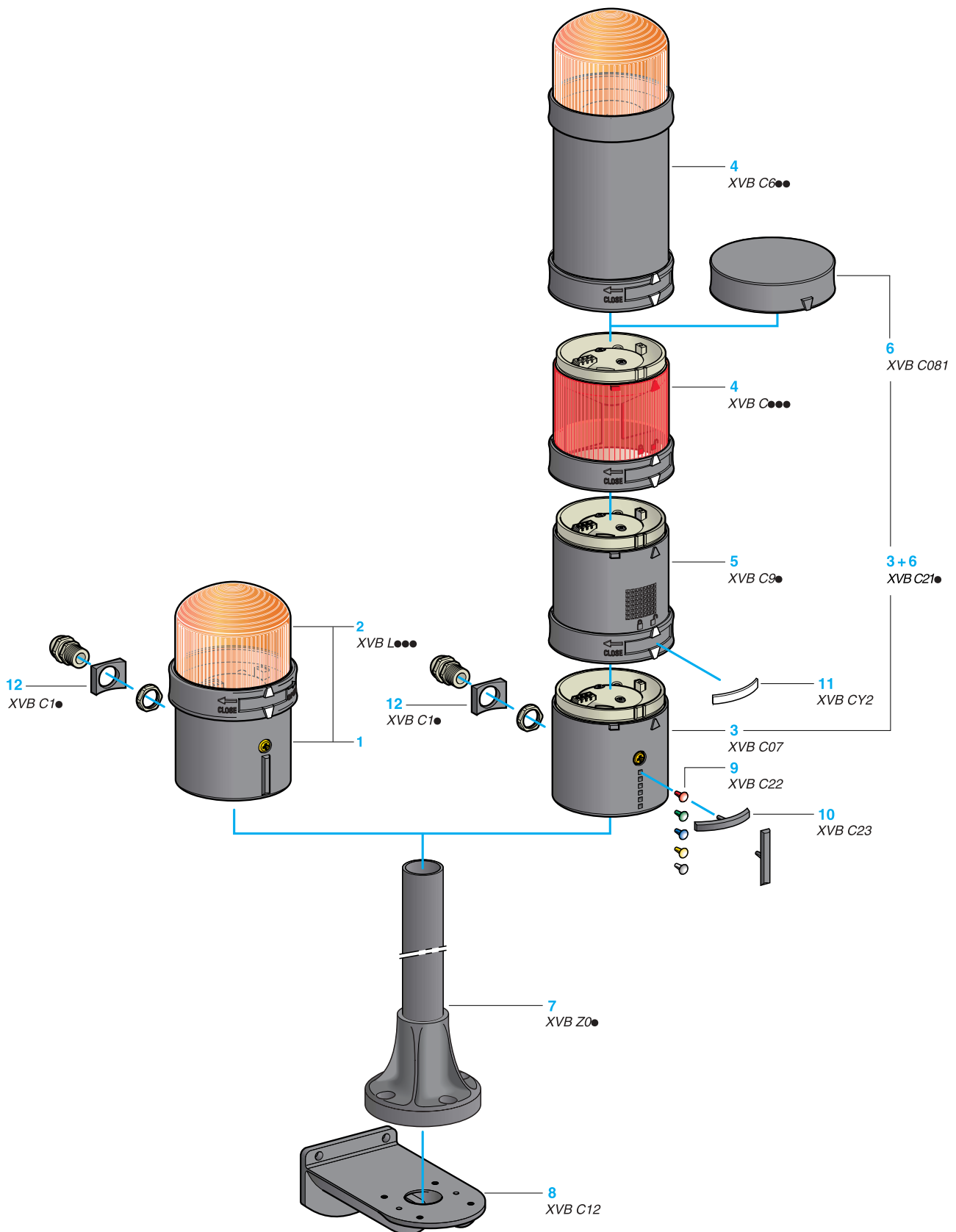

Beacons and indicator banks XVB are visual or audible signalling units and are mainly used for indicating, throughout 360° and at a distance, the various states or operation sequences of a machine or installation.
Examples: start, stop machine, no material, call technical staff, fault signalling, etc.

Illuminated beacon

Complete product

Ready assembled with a single illuminated signalling unit:
☐ steady light (with incandescent bulb or LED),
☐ flashing light (with incandescent bulb or LED), or
☐ "flash" (with discharge tube).

The beacon comprises:

- 1 A base unit with a removable terminal block and bottom or side cable entry.
- 2 One coloured illuminated unit (green, red, orange, blue, clear or yellow).

Indicator bank

Customer assembled product

Variable composition assembly of 1 to 5 illuminated or audible units which are supplied as separate items (assembly by user).

The bank comprises:

- 3 A base unit with a removable terminal block and bottom or side cable entry.
- 4 1 to 5 coloured illuminated units (green, red, orange, blue, clear or yellow).
Maximum configuration: 5 units or 4 units + 1 "flash".
- 5 Or 1 or 2 audible units.
- 6 A top cover (except when using a "flash" discharge tube).

■ The illuminated or audible units stack vertically and are easily locked and unlocked using an integral clamping ring. Electrical connections between each unit are made automatically.

■ Only one "flash" discharge tube unit can be fitted on each indicator bank and it is always mounted on top.

■ Connection on the AS-Interface cabling system is possible by ordering a dedicated base unit. Please refer to our "AS-Interface cabling system" catalogue.

Accessories

For beacons and indicator banks

- 7 Fixing base comprising a support tube glued into a plastic fixing plate, for heights beneath the base unit of 80, 380 or 780 mm.
- 8 Fixing plate for mounting on vertical support.
- 9 Coloured markers (1).
- 10 Legend holder with legend (1).
- 11 Legends that attach to locking ring of each signalling unit for identification.
- 12 Adaptor and 13P cable gland.

(1) These enable the position of the various units (illuminated or audible) to be identified in the event of dismantling the bank.

Installation

Mounting

- Base unit fixed directly onto panel using 2 screws.
- Fixed using a fixing base comprising an aluminium support tube glued into a plastic fixing plate.

Cabling

By means of removable terminal block incorporated in base unit (simplified wiring). The screw and captive cable clamp terminals are protected to prevent any accidental contact with live parts.

Environment characteristics

Product certifications	Standard version		CSA, UL, CCC
Conformity to standards			IEC/EN 60947-5-1
Protective treatment	Standard version		"TC"
Ambient air temperature	For storage	°C	- 40...+ 70
	For operation (1)	°C	Illuminated units with steady light signalling: - 25...+ 70, with 7 W incandescent bulb - 25...+ 50, with LED
		°C	Illuminated units with flashing light signalling: - 25...+ 50, with 7 W incandescent bulb - 25...+ 50, with LED
		°C	Illuminated units with "flash" discharge tube: - 25...+ 50
		°C	Audible units: - 25...+ 50, with buzzer
Electric shock protection Conforming to IEC 536	Mounted on support tube		Class I
	Mounted on base unit		Class II
Degree of protection	Conforming to IEC 60529 and NF C 20-010		IP 65 (mounted on fixing base XVB Z0●) IP 66 (mounted directly on base unit)
	Conforming to UL 508		Type 4X NEMA "Indoor"
Material	Illuminated units		Polycarbonate
	Base unit and cover		Glass-reinforced polyamide and polycarbonate
	Support tube		Painted aluminium
	Fixing plate		Zamak

(1) Warning: illuminated units with incandescent bulbs must not be combined with LED illuminated units, due to the risk of overheating.
Also, when different units (e.g. steady, flashing...) are combined, the maximum temperature is limited to that of the weaker unit.

Electrical characteristics			
Rated insulation voltage (Ui)	Conforming to IEC 60947-1	V	250
Voltage limits	Conforming to IEC 60947-5-1	V	0.85 to 1.10 Un (Un: nominal voltage)
Consumption	LED units	mA	Steady light signalling: ≈ 24 V: < 30 ~ 120...230 V: < 30
		mA	Flashing light signalling: ≈ 24 V: < 40 ~ 120...230 V: < 15
	Units with discharge tube (1)	mA	Flashing light signalling: ≈ 24 V: 5 J unit: < 430; 10 J unit: < 850 ~ 120 V: 5 J unit: < 130; 10 J unit: < 260 ~ 230 V: 5 J unit: < 105; 10 J unit: < 210
	Audible units	mA	≈ 12...48 V: < 20 V ~ 120...230 V: < 50
Rated impulse withstand voltage	Conforming to IEC 60947-1	kV	U imp = 4
Light source	Illuminated units with steady or flashing light signalling		LEDs: degree of pollution 2 Bulbs with BA 15d base fitting, maximum power 7 W
Illuminating power	Units with discharge tube	cds	13 (integral high intensity tube) with clear lens unit: 5 J tube 26 (integral high intensity tube) with clear lens unit: 10 J tube
Audible unit	Continuous or intermittent tone	dB	90 at 1 m
	Fundamental frequency	kHz	2.8
Terminal referencing			1 terminal referenced "C" common to all 5 units
			1 or 5 terminals referenced 1 to 5, depending on number of units
Connection	Maximum clamping capacity on protected, ready-to-tighten, screw and captive cable clamp terminals	mm ²	1 x 1.5 with cable end
Frequency of illuminated units	Illuminated units with flashing light signalling	Hz	1
	Illuminated units with discharge tube	Hz	1

(1) **Warning:** illuminated units with a flash discharge tube are not suitable for steady light signalling due to the heat generated.

Beacons and indicator banks

Illuminated beacons Ø 70 mm Universal,
Harmony type XVB L

For incandescent bulbs or LEDs (BA 15d base fitting)



XVB L3●



XVB L4B●

Illuminated beacons with steady light signalling

Description	Light source, to be ordered separately (1)	Colour	Reference	Weight kg
Complete unit comprising: - 1 illuminated unit - 1 base unit (direct or tube fixing)	Incandescent bulb 7 W max. 250 V max.	Green	XVB L33	0.260
		Red	XVB L34	0.260
		Orange	XVB L35	0.260
		Blue	XVB L36	0.260
		Clear	XVB L37	0.260
		Yellow	XVB L38	0.260

Illuminated beacons with integral flashing light signalling

Description	Light source, to be ordered separately (1)	Colour	Reference	Weight kg
Complete unit comprising: - 1 illuminated unit - 1 base unit (direct or tube fixing)	Incandescent bulb 7 W max. ~ 24 V --- 24...48 V	Green	XVB L4B3	0.280
		Red	XVB L4B4	0.280
		Orange	XVB L4B5	0.280
		Blue	XVB L4B6	0.280
		Clear	XVB L4B7	0.280
		Yellow	XVB L4B8	0.280
	Incandescent bulb 7 W max. ~ 48...230 V	Green	XVB L4M3	0.280
		Red	XVB L4M4	0.280
		Orange	XVB L4M5	0.280
		Blue	XVB L4M6	0.280
		Clear	XVB L4M7	0.280
		Yellow	XVB L4M8	0.280

(1) Incandescent bulbs and LEDs, see page 4/41.

Beacons and indicator banks

Illuminated beacons Ø 70 mm Universal,
Harmony type XVB L
With LED light source



XVB L0B●

Illuminated beacons with steady light signalling

Description	Light source	Colour	Reference	Weight kg
Complete unit comprising: - 1 cover - 1 illuminated unit - 1 base unit (direct or tube fixing)	LED, included ~ 24 V	Green	XVB L0B3	0.270
		Red	XVB L0B4	0.270
		Orange	XVB L0B5	0.270
		Blue	XVB L0B6	0.270
		Clear	XVB L0B7	0.270
		Yellow	XVB L0B8	0.270
	LED, included ~ 120 V	Green	XVB L0G3	0.270
		Red	XVB L0G4	0.270
		Orange	XVB L0G5	0.270
		Blue	XVB L0G6	0.270
		Clear	XVB L0G7	0.270
		Yellow	XVB L0G8	0.270
	LED, included ~ 230 V	Green	XVB L0M3	0.270
		Red	XVB L0M4	0.270
		Orange	XVB L0M5	0.270
		Blue	XVB L0M6	0.270
		Clear	XVB L0M7	0.270
		Yellow	XVB L0M8	0.270



XVB L1B●

Illuminated beacons with integral flashing light signalling

Description	Light source	Colour	Reference	Weight kg
Complete unit comprising: - 1 cover - 1 illuminated unit - 1 base unit (direct or tube fixing)	LED, included ~ 24 V	Green	XVB L1B3	0.280
		Red	XVB L1B4	0.280
		Orange	XVB L1B5	0.280
		Blue	XVB L1B6	0.280
		Clear	XVB L1B7	0.280
		Yellow	XVB L1B8	0.280
	LED, included ~ 120 V	Green	XVB L1G3	0.280
		Red	XVB L1G4	0.280
		Orange	XVB L1G5	0.280
		Blue	XVB L1G6	0.280
		Clear	XVB L1G7	0.280
		Yellow	XVB L1G8	0.280
	LED, included ~ 230 V	Green	XVB L1M3	0.280
		Red	XVB L1M4	0.280
		Orange	XVB L1M5	0.280
		Blue	XVB L1M6	0.280
		Clear	XVB L1M7	0.280
		Yellow	XVB L1M8	0.280

Beacons and indicator banks

Illuminated beacons Ø 70 mm Universal,
Harmony type XVB L
With “flash” discharge tube

4



XVB L6B●



XVB L8B●

Illuminated beacons with 5 Joule “flash” discharge tube

Description	Light source	Colour	Reference	Weight kg
Complete unit comprising: <ul style="list-style-type: none">- 1 cover- 1 illuminated unit- 1 base unit (direct or tube fixing)	Integral “flash” discharge tube ≈ 24 V	Green	XVB L6B3	0.440
		Red	XVB L6B4	0.440
		Orange	XVB L6B5	0.440
		Blue	XVB L6B6	0.440
		Clear	XVB L6B7	0.440
		Yellow	XVB L6B8	0.440
	Integral “flash” discharge tube ~ 120 V	Green	XVB L6G3	0.425
		Red	XVB L6G4	0.425
		Orange	XVB L6G5	0.425
		Blue	XVB L6G6	0.425
		Clear	XVB L6G7	0.425
		Yellow	XVB L6G8	0.425
	Integral “flash” discharge tube ~ 230 V	Green	XVB L6M3	0.435
		Red	XVB L6M4	0.435
		Orange	XVB L6M5	0.435
		Blue	XVB L6M6	0.435
		Clear	XVB L6M7	0.435
		Yellow	XVB L6M8	0.435

Illuminated beacons with 10 Joule “flash” discharge tube

Description	Light source	Colour	Reference	Weight kg
Complete unit comprising: <ul style="list-style-type: none">- 1 cover- 1 illuminated unit- 1 base unit (direct or tube fixing)	Integral “flash” discharge tube ≈ 24 V	Green	XVB L8B3	0.450
		Red	XVB L8B4	0.450
		Orange	XVB L8B5	0.450
		Blue	XVB L8B6	0.450
		Clear	XVB L8B7	0.450
		Yellow	XVB L8B8	0.450
	Integral “flash” discharge tube ~ 120 V	Green	XVB L8G3	0.460
		Red	XVB L8G4	0.460
		Orange	XVB L8G5	0.460
		Blue	XVB L8G6	0.460
		Clear	XVB L8G7	0.460
		Yellow	XVB L8G8	0.460
	Integral “flash” discharge tube ~ 230 V	Green	XVB L8M3	0.460
		Red	XVB L8M4	0.460
		Orange	XVB L8M5	0.460
		Blue	XVB L8M6	0.460
		Clear	XVB L8M7	0.460
		Yellow	XVB L8M8	0.460

For use with base unit XVB C●●: see page 4/40

Beacons and indicator banks

Indicator banks Ø 70 mm Universal,
Harmony type XVB C (for customer assembly, up to 5 units)
Illuminated units for incandescent bulbs or LEDs
(BA 15d base fitting)



XVB C3●



XVB C4●●

Illuminated units with steady light signalling				
Description	Light source, to be ordered separately (1)	Colour	Reference	Weight kg
Illuminated units	Incandescent bulb 7 W max. 250 V max. or LED	Green	XVB C33	0.140
		Red	XVB C34	0.140
		Orange	XVB C35	0.140
		Blue	XVB C36	0.140
		Clear	XVB C37	0.140
		Yellow	XVB C38	0.140

Illuminated units with integral flashing light signalling				
Description	Light source, to be ordered separately (1)	Colour	Reference	Weight kg
Illuminated units	Incandescent bulb 7 W max. ~ 24 V = 24...48 V or LED	Green	XVB C4B3	0.160
		Red	XVB C4B4	0.160
		Orange	XVB C4B5	0.160
		Blue	XVB C4B6	0.160
		Clear	XVB C4B7	0.160
		Yellow	XVB C4B8	0.160
	Incandescent bulb 7 W max. ~ 48...230 V or LED	Green	XVB C4M3	0.160
		Red	XVB C4M4	0.160
		Orange	XVB C4M5	0.160
		Blue	XVB C4M6	0.160
		Clear	XVB C4M7	0.160
		Yellow	XVB C4M8	0.160

(1) Incandescent bulbs and LEDs, see page 4/41.

For use with base unit XVB C●●: see page 4/40

Beacons and indicator banks

Indicator banks Ø 70 mm Universal,
Harmony type XVB C (for customer assembly, up to 5 units)
Illuminated units with integral LED



XVB C2●●

Illuminated units with steady light signalling				
Description	Voltage	Colour	Reference	Weight kg
Illuminated units with integral LED	≈ 24 V	Green	XVB C2B3	0.150
		Red	XVB C2B4	0.150
		Orange	XVB C2B5	0.150
		Blue	XVB C2B6	0.150
		Clear	XVB C2B7	0.150
		Yellow	XVB C2B8	0.150
	~ 120 V	Green	XVB C2G3	0.150
		Red	XVB C2G4	0.150
		Orange	XVB C2G5	0.150
		Blue	XVB C2G6	0.150
		Clear	XVB C2G7	0.150
		Yellow	XVB C2G8	0.150
	~ 230 V	Green	XVB C2M3	0.150
		Red	XVB C2M4	0.150
		Orange	XVB C2M5	0.150
		Blue	XVB C2M6	0.150
		Clear	XVB C2M7	0.150
		Yellow	XVB C2M8	0.150

Illuminated units with integral flashing light signalling				
Description	Voltage	Colour	Reference	Weight kg
Illuminated units with integral LED	≈ 24 V	Green	XVB C5B3	0.170
		Red	XVB C5B4	0.170
		Orange	XVB C5B5	0.170
		Blue	XVB C5B6	0.170
		Clear	XVB C5B7	0.170
		Yellow	XVB C5B8	0.170
	~ 120 V	Green	XVB C5G3	0.170
		Red	XVB C5G4	0.170
		Orange	XVB C5G5	0.170
		Blue	XVB C5G6	0.170
		Clear	XVB C5G7	0.170
		Yellow	XVB C5G8	0.170
	~ 230 V	Green	XVB C5M3	0.170
		Red	XVB C5M4	0.170
		Orange	XVB C5M5	0.170
		Blue	XVB C5M6	0.170
		Clear	XVB C5M7	0.170
		Yellow	XVB C5M8	0.170



XVB C5●●

For use with base unit XVB C●●: see page 4/40



XVB C6●●



XVB C8●●

Beacons and indicator banks

Indicator banks Ø 70 mm Universal,
Harmony type XVB C (for customer assembly, up to 5 units)
Illuminated units with integral “flash” discharge tube

Illuminated units with 5 Joule “flash” discharge tube

Description	Light source	Colour	Reference	Weight kg
Illuminated units	Integral “flash” discharge tube ≈ 24 V	Green	XVB C6B3	0.295
		Red	XVB C6B4	0.295
		Orange	XVB C6B5	0.295
		Blue	XVB C6B6	0.295
		Clear	XVB C6B7	0.295
		Yellow	XVB C6B8	0.295
	Integral “flash” discharge tube ~ 120 V	Green	XVB C6G3	0.280
		Red	XVB C6G4	0.280
		Orange	XVB C6G5	0.280
		Blue	XVB C6G6	0.280
		Clear	XVB C6G7	0.280
		Yellow	XVB C6G8	0.280
	Integral “flash” discharge tube ~ 230 V	Green	XVB C6M3	0.290
		Red	XVB C6M4	0.290
		Orange	XVB C6M5	0.290
		Blue	XVB C6M6	0.290
		Clear	XVB C6M7	0.290
		Yellow	XVB C6M8	0.290

Illuminated units with 10 Joule “flash” discharge tube

Description	Light source	Colour	Reference	Weight kg
Illuminated units	Integral “flash” discharge tube ≈ 24 V	Green	XVB C8B3	0.305
		Red	XVB C8B4	0.305
		Orange	XVB C8B5	0.305
		Blue	XVB C8B6	0.305
		Clear	XVB C8B7	0.305
		Yellow	XVB C8B8	0.305
	Integral “flash” discharge tube ~ 120 V	Green	XVB C8G3	0.315
		Red	XVB C8G4	0.315
		Orange	XVB C8G5	0.315
		Blue	XVB C8G6	0.315
		Clear	XVB C8G7	0.315
		Yellow	XVB C8G8	0.315
	Integral “flash” discharge tube ~ 230 V	Green	XVB C8M3	0.315
		Red	XVB C8M4	0.315
		Orange	XVB C8M5	0.315
		Blue	XVB C8M6	0.315
		Clear	XVB C8M7	0.315
		Yellow	XVB C8M8	0.315

Beacons and indicator banks

Indicator banks Ø 70 mm Universal,
Harmony type XVB C (for customer assembly, up to 5 units)
Audible units, base units, cover, accessories

Audible units

Description	Characteristics	Reference	Weight kg
Buzzer, 90 dB at 1 m Adjustable: - 70 or 90 dB - continuous or intermittent tone using microswitch	≈ 12...48 V ~ 120...230 V	XVB C9B XVB C9M	0.170 0.180

Base units (for direct or tube fixing)

Description	For use with	Type	Reference	Weight kg
Base unit + cover with bottom or side cable entry	Banks without "flash" discharge tube unit	Standard	XVB C21	0.190
Base unit only with bottom or side cable entry	Banks with "flash" discharge tube unit	Standard	XVB C07	0.160
Base unit + cover with side cable entry	All types of bank	AS-Interface (1)	XVB C21A	—
Base unit + cover with bottom entry, pre-cabled (length 1 metre) and fitted with M12 end connector	All types of bank	AS-Interface (1)	XVB C21B	—

(1) For further information on AS-Interface connections, refer to our "AS-Interface cabling system" catalogue.

Accessories common to beacons and indicator banks

Description	Height under base unit mm	Colour	Reference	Weight kg
Fixing bases comprising: Ø 25 mm aluminium support tube glued into black plastic fixing plate	80	Black aluminium	XVB Z02	0.110
		Aluminium	XVB Z02A	0.110
	380	Black aluminium	XVB Z03	0.200
		Aluminium	XVB Z03A	0.200
	780	Black aluminium	XVB Z04	0.325
		Aluminium	XVB Z04A	0.325
Description	For use with	Material	Reference	Weight kg
Fixing plate for use on horizontal support	Ø 25 mm aluminium support tube (to be glued into plastic fixing plate)	Plastic	XVB Z01	0.050
Fixing plate for use on vertical support	Base unit (direct mounting), fixing plate XVB Z01 or fixing bases XVB Z0●	Zamak	XVB C12	0.380

Beacons and indicator banks

Beacons and indicator banks Ø 70 mm

Universal, Harmony type XVB

Accessories

Accessories common to beacons and indicator banks (continued)

Description	Characteristics		Sold in lots of	Unit reference	Weight kg
Incandescent bulbs BA 15d base fitting	12 V	7 W	10	DL1 BEJ	0.090
	24 V	6.5 W	10	DL1 BEB	0.090
	48 V	6 W	10	DL1 BEE	0.090
	120 V	7 W	10	DL1 BEG	0.090
	230 V	7 W	10	DL1 BEM	0.090
LEDs BA 15d base fitting 	24 V	White	1	DL1 BDB1	0.015
		Green	1	DL1 BDB3	0.015
		Red	1	DL1 BDB4	0.015
		Orange	1	DL1 BDB5	0.015
		Blue	1	DL1 BDB6	0.015
	120 V	Yellow	1	DL1 BDB8	0.015
		White	1	DL1 BDG1	0.015
		Green	1	DL1 BDG3	0.015
		Red	1	DL1 BDG4	0.015
		Orange	1	DL1 BDG5	0.015
	230 V	Blue	1	DL1 BDG6	0.015
		Yellow	1	DL1 BDG8	0.015
		White	1	DL1 BDM1	0.015
		Green	1	DL1 BDM3	0.015
		Red	1	DL1 BDM4	0.015
		Orange	1	DL1 BDM5	0.015
		Blue	1	DL1 BDM6	0.015
		Yellow	1	DL1 BDM8	0.015
Flashing LEDs BA 15d base fitting 	24 V	White	1	DL1 BKB1	0.015
		Green	1	DL1 BKB3	0.015
		Red	1	DL1 BKB4	0.015
		Orange	1	DL1 BKB5	0.015
		Blue	1	DL1 BKB6	0.015
	120 V	Yellow	1	DL1 BKB8	0.015
		White	1	DL1 BKG1	0.015
		Green	1	DL1 BKG3	0.015
		Red	1	DL1 BKG4	0.015
		Orange	1	DL1 BKG5	0.015
	230 V	Blue	1	DL1 BKG6	0.015
		Yellow	1	DL1 BKG8	0.015
		White	1	DL1 BKM1	0.015
		Green	1	DL1 BKM3	0.015
		Red	1	DL1 BKM4	0.015
		Orange	1	DL1 BKM5	0.015
		Blue	1	DL1 BKM6	0.015
		Yellow	1	DL1 BKM8	0.015

Accessories specific to indicator banks

Description	Characteristics	Sold in lots of	Unit reference	Weight kg
Cover only	—	—	XVB C081	0.030
Set of coloured markers	6 colours	—	XVB C22	0.001
Set of 5 legend holders	Identification of stacked units on base unit	—	XVB C23	0.002
Sheet of 85 legends for base unit legend holder (XVB C23)	Identification of stacked units on base unit	—	XVB CY1	0.005
Sheet of 52 legends	Identification of stacked units on locking ring	—	XVB CY2	0.005
Adaptor for side entry through base unit	With 13P cable gland	1	XVB C14	0.015
SIS labelling software creation of legends	For English, French, German, Italian and Spanish	—	XBY 2U	0.100

Dimensions

Illuminated beacons XVB L●●●

For BA 15d bulb or LED

With "flash" discharge tube unit

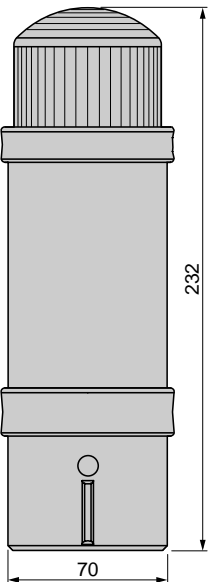
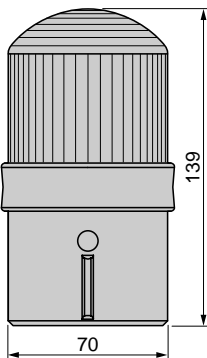

4

Indicator banks XVB C●●●

Without "flash" discharge tube unit

With "flash" discharge tube unit

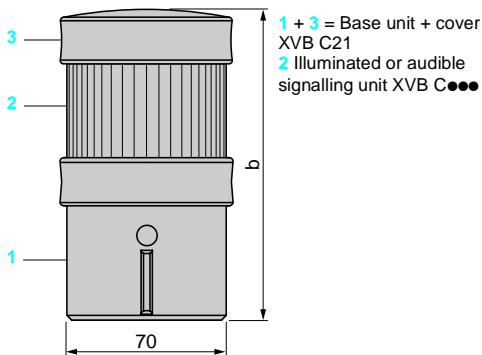

1 + 3 = Base unit + cover
XVB C21
2 Illuminated or audible
signalling unit XVB C●●●

Number of illuminated or audible signalling units (no "flash")	b
1	138
2	201
3	264
4	327
5	390

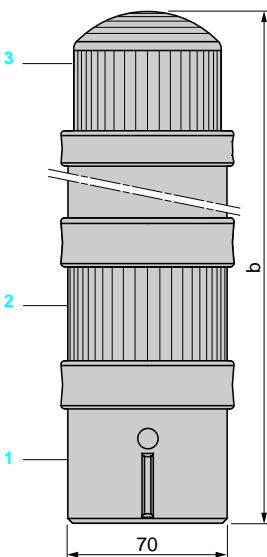

1 Base unit XVB C07
2 Illuminated or audible signalling unit
XVB C●●●
3 "Flash" unit XVB C●●●

Number of illuminated or audible signalling units other than "flash" tube	b
1	295
2	358
3	421
4	484

Panel cut-out for direct fixing

On base unit XVB C21, XVB C07, XVB C21A or XVB C21B

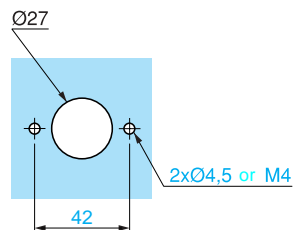

Dimensions

With fixing bases comprising XVB Z0● (aluminium support tube glued into black plastic fixing plate)

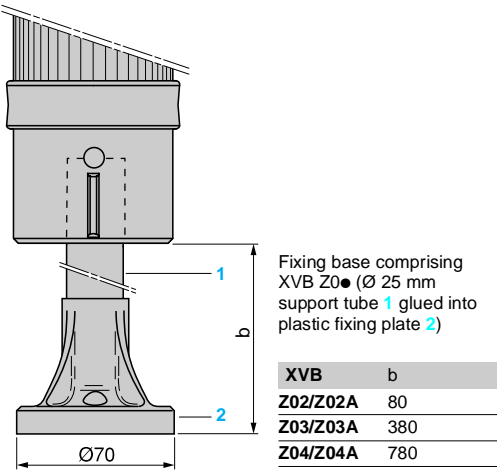

Fixing base comprising
XVB Z0● (Ø 25 mm
support tube 1 glued into
plastic fixing plate 2)

XVB	b
Z02/Z02A	80
Z03/Z03A	380
Z04/Z04A	780

Horizontal support panel cut-out for mounting on fixing plate

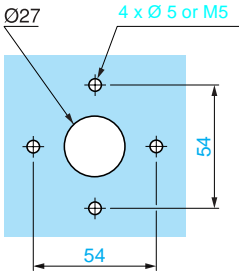

With fixing plate XVB C12 for use on vertical support

Direct mounting on base unit

Mounting using fixing base XVB Z0●
(aluminium support tube glued into black
plastic fixing plate)

Vertical support panel drillings for
mounting fixing plate XVB C12

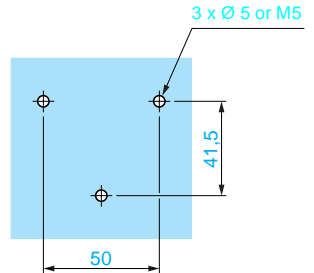
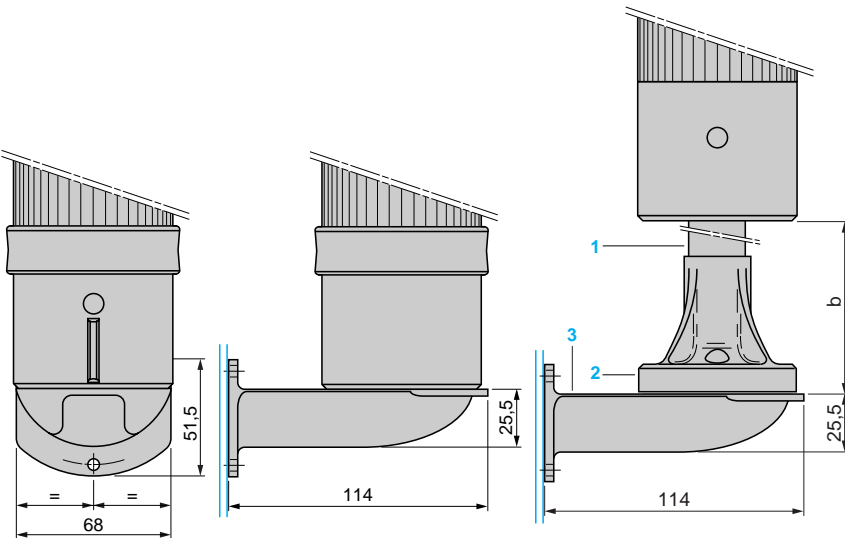

Fixing base comprising XVB Z0● (Ø 25 mm
support tube 1 glued into plastic fixing plate 2)
mounted on fixing plate XVB C12 for vertical
support 3

XVB	b
Z02/Z02A	80
Z03/Z03A	380
Z04/Z04A	780

Installation

Connections

XVB L

XVB C

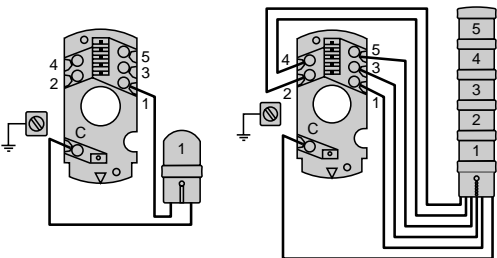

Adjustment of audible signal for buzzers type XVB C9●

By means of 4 microswitches located in the base of the buzzer:

- 2 switches marked 1 and 2 for selecting continuous or intermittent mode (Hz).
- 2 switches marked 3 and 4 for selecting the power (dB) of the audible signal.

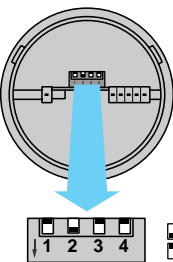

Position of microswitches		Setting
1	2	Mode
1	1	— 2.8 kHz
1	0	— 2.8 kHz
0	1	⏏ 5 Hz (1)
0	0	⏏ 1 Hz
3	4	Power
1	1	90 dB (1)
0	1	85 dB
1	0	80 dB
0	0	70 dB

(1) Factory setting.

Beacons and indicator banks

Beacons and indicator banks Ø 70 mm Application, Harmony type XVD

4

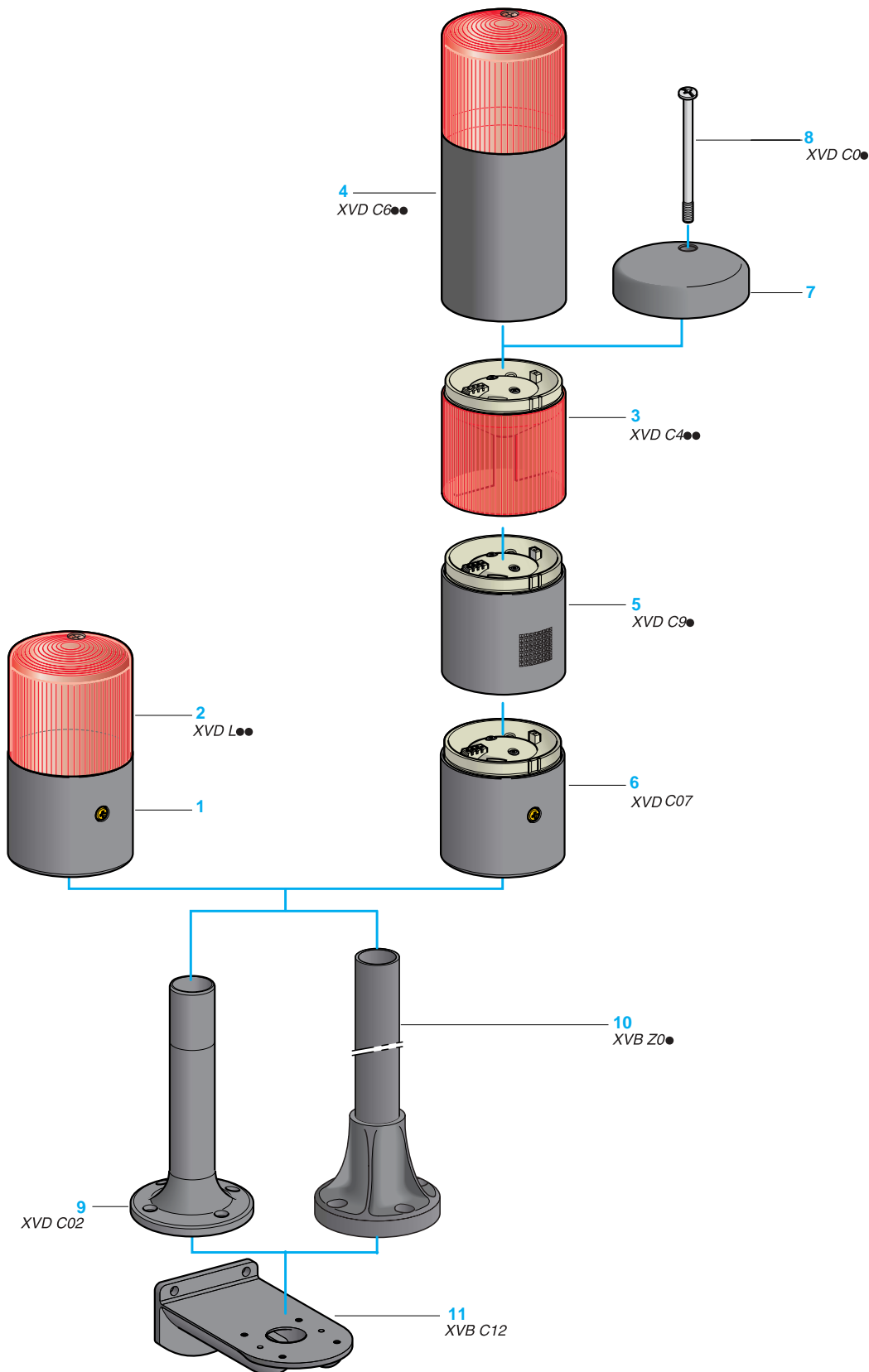

Beacons and indicator banks XVD are visual or audible signalling units and are mainly used for indicating, throughout 360° and at a distance, the various states or operation sequences of a machine or installation.
Examples: start, stop machine, no material, call technical staff, fault signalling, etc.

Illuminated beacon

Complete product

Ready assembled with a single illuminated signalling unit:

- Steady light (with incandescent bulb or LED).
- Flashing light (with incandescent bulb or LED).
- Or "flash" (with discharge tube).

The beacon comprises:

- 1 A base unit with a removable terminal block and bottom cable entry.
- 2 One coloured illuminated unit (green, red, orange, blue, clear or yellow).

Indicator bank

Customer assembled product

Variable composition assembly of 1 to 5 illuminated or audible units which are supplied as separate items (assembly by user).

The bank comprises:

- 3 1 to 5 coloured illuminated units (green, red, orange, blue, clear or yellow).
- 4 An illuminated unit with "flash" discharge tube (only 1 per bank), which is always mounted at the top of the bank.
- 5 Or 1 audible unit (buzzer).
- 6 A base unit with a removable terminal block and bottom cable entry.
- 7 A top cover (except when using a "flash" discharge tube).
- 8 An assembly screw that passes through the whole bank.

- The illuminated or audible units stack vertically and are easily fitted together using a single screw.
- Electrical connections between each unit are made automatically.

Accessories

For beacons and indicator banks

- 9 Integral support tube and fixing plate, height 100 mm (clamping device on base unit).
- 10 Fixing base comprising a support tube glued into a plastic fixing plate, for heights beneath the base unit of 80, 380 or 780 mm.
- 11 Fixing plate for mounting on vertical support.

Installation

Mounting

- Base unit fixed directly onto panel using 2 screws.
- Fixed using a fixing base comprising an aluminium support tube glued into a black plastic fixing plate.

Cabling

By means of removable terminal block incorporated in base unit (simplified wiring).
The screw and captive cable clamp terminals are protected to prevent any accidental contact with live parts.

Environment characteristics

Conformity to standards			IEC/EN 60947-5-1
Protective treatment	Standard version		"TC"
Ambient air temperature	For storage	°C	- 40...+ 70
	For operation (1)	°C	Illuminated units with steady light signalling: - 25...+ 70, with 7 W max. incandescent bulb - 25...+ 50, with LED
		°C	Illuminated units with flashing light signalling: - 25...+ 50, with 7 W max. incandescent bulb - 25...+ 50, with LED
		°C	Illuminated units with "flash" discharge tube: - 25...+ 50
Electric shock protection Conforming to IEC 536	Mounted on support tube		Class I
	Mounted on base unit		Class II
Degree of protection	Conforming to IEC 529 and NF C 20-010		IP 40
	Conforming to UL 508		NEMA 1
Material	Illuminated units		Polycarbonate
	Base unit and cover		Glass-reinforced polyamide and polycarbonate
	Support tube		Painted aluminium
	Fixing plate		Zamak

(1) Warning: illuminated units with incandescent bulbs must not be combined with LED illuminated units, due to the risk of overheating.
Also, when different units (e.g. steady, flashing...) are combined, the maximum temperature is limited to that of the weaker unit.

Electrical characteristics			
Rated insulation voltage (Ui)	Conforming to IEC 947-1	V	250
Voltage limits	Conforming to IEC 947-5-1	V	0.85 to 1.10 Un (Un: nominal voltage)
Consumption	LED unit	mA	Steady light signalling: ≈ 24 V: < 75 ~ 120: < 25
		mA	Flashing light signalling: ≈ 24 V: < 80 ~ 120...230 V: < 30
	Discharge tube unit (on energisation)	mA	≈ 24 V: 5 J unit: < 430
		mA	~ 120 V: 5 J unit: < 130
		mA	~ 230 V: 5 J unit: < 105
	Audible units	mA	≈ 12...48 V: < 20
		mA	~ 120...230 V: < 50
Rated impulse withstand voltage	Conforming to IEC 947-1	kV	U imp = 4
Light source	Illuminated units with steady or flashing light signalling		Incandescent bulbs with BA 15d base fitting, maximum power 7 W LEDs with BA 15d base fitting
Illuminating power	Illuminated units with discharge circuit (flash lamp with integral tube)	cds	13 (integral high intensity tube) with clear lens unit: 5 J tube
Audible unit	Continuous or intermittent tone	dB	90 at 1 m (adjustable: 70...90 dB)
	Fundamental frequency	kHz	2.8
Terminal referencing	Common to all 5 units		1 terminal referenced "C"
	Depending on number of units		1 or 5 terminals referenced 1 to 5
Connection	Maximum clamping capacity on protected, ready-to-tighten, screw and captive cable clamp terminals	mm ²	1 x 1.5 with cable end
Frequency of illuminated units	Illuminated units with flashing light signalling	Hz	1
	Illuminated units with discharge tube	Hz	1

Beacons and indicator banks

Illuminated beacons Ø 70 mm Application,
Harmony type XVD, for customer assembly



XVD L3●



XVD L4B●

Illuminated beacons with steady light signalling

Description	Light source, to be ordered separately (1)	Colour	Reference	Weight kg
Complete unit comprising: - 1 illuminated unit - 1 base unit	Incandescent bulb 7 W max. 250 V max.	Green	XVD L33	0.255
		Red	XVD L34	0.255
		Orange	XVD L35	0.255
		Blue	XVD L36	0.255
		Clear	XVD L37	0.255
		Yellow	XVD L38	0.255

Illuminated beacons with integral flashing light signalling

Description	Light source, to be ordered separately	Colour	Reference	Weight kg
Complete unit comprising: - 1 illuminated unit - 1 base unit	Incandescent bulb 7 W max. ~ 24 V --- 24...48 V	Green	XVD L4B3	0.275
		Red	XVD L4B4	0.275
		Orange	XVD L4B5	0.275
		Blue	XVD L4B6	0.275
		Clear	XVD L4B7	0.275
		Yellow	XVD L4B8	0.275
	Incandescent bulb 7 W max. ~ 48...230 V	Green	XVD L4M3	0.275
		Red	XVD L4M4	0.275
		Orange	XVD L4M5	0.275
		Blue	XVD L4M6	0.275
		Clear	XVD L4M7	0.275
		Yellow	XVD L4M8	0.275

Illuminated beacons with 5 Joule "flash" discharge tube

Description	Light source	Colour	Reference	Weight kg
Complete unit comprising: - 1 illuminated unit - 1 base unit	Integral "flash" discharge tube ~ 24 V	Green	XVD L6B3	0.480
		Red	XVD L6B4	0.480
		Orange	XVD L6B5	0.480
		Blue	XVD L6B6	0.480
		Clear	XVD L6B7	0.480
		Yellow	XVD L6B8	0.480
	Integral "flash" discharge tube ~ 230 V	Green	XVD L6M3	0.475
		Red	XVD L6M4	0.475
		Orange	XVD L6M5	0.475
		Blue	XVD L6M6	0.475
		Clear	XVD L6M7	0.475
		Yellow	XVD L6M8	0.475



XVD L6B●●

(1) Incandescent bulbs and LEDs, see page 4/51.

Beacons and indicator banks

Indicator banks Ø 70 mm Application,
Harmony type XVD (variable composition of up to 5 units),
for customer assembly
Illuminated units

For use with base unit XVD C●●: see page 4/50

Illuminated units with steady light signalling

Description	Light source, to be ordered separately	Colour	Reference	Weight kg
Illuminated units	Incandescent bulb 7 W max. 250 V max.	Green	XVD C33	0.115
		Red	XVD C34	0.115
		Orange	XVD C35	0.115
		Blue	XVD C36	0.115
		Clear	XVD C37	0.115
		Yellow	XVD C38	0.115

Illuminated units with integral flashing light signalling

Description	Light source, to be ordered separately	Colour	Reference	Weight kg
Illuminated units	Incandescent bulb 7 W max. ~ 24 V --- 24...48 V	Green	XVD C4B3	0.135
		Red	XVD C4B4	0.135
		Orange	XVD C4B5	0.135
		Blue	XVD C4B6	0.135
		Clear	XVD C4B7	0.135
		Yellow	XVD C4B8	0.135
	Incandescent bulb 7 W max. ~ 48...230 V	Green	XVD C4M3	0.135
		Red	XVD C4M4	0.135
		Orange	XVD C4M5	0.135
		Blue	XVD C4M6	0.135
		Clear	XVD C4M7	0.135
		Yellow	XVD C4M8	0.135



XVD C4●●

4

Illuminated units with 5 Joule “flash” discharge tube

Description	Light source	Colour	Reference	Weight kg
Illuminated units	Integral “flash” discharge tube ~ 24 V	Green	XVD C6B3	0.310
		Red	XVD C6B4	0.310
		Orange	XVD C6B5	0.310
		Blue	XVD C6B6	0.310
		Clear	XVD C6B7	0.310
		Yellow	XVD C6B8	0.310
	Integral “flash” discharge tube ~ 230 V	Green	XVD C6M3	0.310
		Red	XVD C6M4	0.310
		Orange	XVD C6M5	0.310
		Blue	XVD C6M6	0.310
		Clear	XVD C6M7	0.310
		Yellow	XVD C6M8	0.310



XVD C6●●

Beacons and indicator banks

Illuminated beacons Ø 70 mm Application,
Harmony type XVD, for customer assembly
Audible units, base units and accessories



XVD C9●



XVD C07



XVB Z02



XVB Z03/Z04

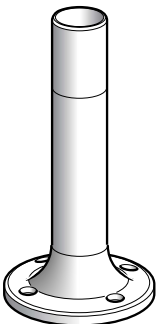

XVD C02

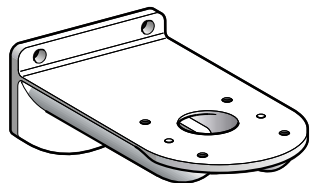

XVB C12

Audible units

Description	Characteristics	Reference	Weight kg
Buzzer, 90 dB at 1 m Adjustable, 70 or 90 dB, continuous or intermittent tone, using microswitch	≈ 12...48 V	XVD C9B	0.150
	~ 120...230 V	XVD C9M	0.150

Base units (for direct or tube fixing)

Description	For use with	Type	Reference	Weight kg
Base unit + cover with bottom cable entry	Banks without "flash" discharge tube unit	Standard	XVD C21	0.180
Base unit only with bottom cable entry	Banks with "flash" discharge tube unit	Standard	XVD C07	0.160
Screw for assembling signalling units on base unit	Banks without "flash" discharge tube unit	1 unit	XVD C03	0.015
		2 units	XVD C04	0.022
		3 units	XVD C05	0.030
		4 units	XVD C06	0.038
		5 units	XVD C08	0.045
	Banks with "flash" discharge tube unit	1 unit	XVD C09	0.036
		2 units	XVD C10	0.044
		3 units	XVD C11	0.050
		4 units	XVD C12	0.059

Accessories common to beacons and indicator banks

Description	Height under base unit (mm)	Colour	Reference	Weight kg
Fixing bases comprising: Ø 25 mm aluminium support tube glued into black plastic fixing plate	80	Black aluminium	XVB Z02	0.110
		Aluminium	XVB Z02A	0.110
	380	Black aluminium	XVB Z03	0.200
		Aluminium	XVB Z03A	0.200
	780	Black aluminium	XVB Z04	0.325
		Aluminium	XVB Z04A	0.325

Description	Characteristics	Reference	Weight kg
Integral support tube and plastic fixing plate, colour black	100 mm	XVD C02	0.070
Zamak fixing plate for use on vertical support	Direct mounting on base unit or with integral support tube and fixing plate XVD C02 or with fixing bases XVB Z0●	XVB C12	0.380
Cover only	–	XVD C081	0.020

Beacons and indicator banks

Beacons and indicator banks Ø 70 mm

Application, Harmony type XVD

Accessories

Accessories common to beacons and indicator banks (continued)

Description	Characteristics		Sold in lots of	Unit reference	Weight kg
Incandescent bulbs BA 15d base fitting	12 V	7 W	10	DL1 BEJ	0.090
	24 V	6.5 W	10	DL1 BEB	0.090
	48 V	6 W	10	DL1 BEE	0.090
	120 V	7 W	10	DL1 BEG	0.090
	230 V	7 W	10	DL1 BEM	0.090
LEDs BA 15d base fitting Protected LED	24 V	White	1	DL1 BDB1	0.015
		Green	1	DL1 BDB3	0.015
		Red	1	DL1 BDB4	0.015
		Orange	1	DL1 BDB5	0.015
		Blue	1	DL1 BDB6	0.015
		Yellow	1	DL1 BDB8	0.015
	120 V	White	1	DL1 BDG1	0.015
		Green	1	DL1 BDG3	0.015
		Red	1	DL1 BDG4	0.015
		Orange	1	DL1 BDG5	0.015
		Blue	1	DL1 BDG6	0.015
		Yellow	1	DL1 BDG8	0.015
	230 V	White	1	DL1 BDM1	0.015
		Green	1	DL1 BDM3	0.015
		Red	1	DL1 BDM4	0.015
		Orange	1	DL1 BDM5	0.015
		Blue	1	DL1 BDM6	0.015
		Yellow	1	DL1 BDM8	0.015
Flashing LEDs BA 15d base fitting Protected LED	24 V	White	1	DL1 BKB1	0.015
		Green	1	DL1 BKB3	0.015
		Red	1	DL1 BKB4	0.015
		Orange	1	DL1 BKB5	0.015
		Blue	1	DL1 BKB6	0.015
		Yellow	1	DL1 BKB8	0.015
	120 V	White	1	DL1 BKG1	0.015
		Green	1	DL1 BKG3	0.015
		Red	1	DL1 BKG4	0.015
		Orange	1	DL1 BKG5	0.015
		Blue	1	DL1 BKG6	0.015
		Yellow	1	DL1 BKG8	0.015
	230 V	White	1	DL1 BKM1	0.015
		Green	1	DL1 BKM3	0.015
		Red	1	DL1 BKM4	0.015
		Orange	1	DL1 BKM5	0.015
		Blue	1	DL1 BKM6	0.015
		Yellow	1	DL1 BKM8	0.015

Dimensions

Illuminated beacons XVD L●●●

For BA 15d bulb or LED

With “flash” discharge tube unit

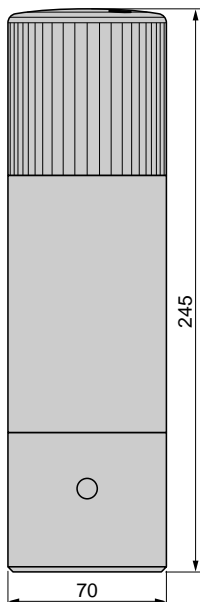
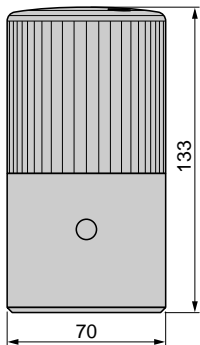

Indicator banks XVD C●●

Without “flash” discharge tube unit

With “flash” discharge tube unit

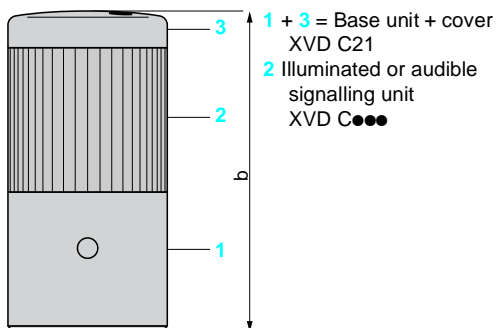

- 1 + 3 = Base unit + cover XVD C21
- 2 Illuminated or audible signalling unit XVD C●●●

Number of illuminated or audible signalling units (no “flash”)	b
1	140
2	203
3	266
4	329
5	392

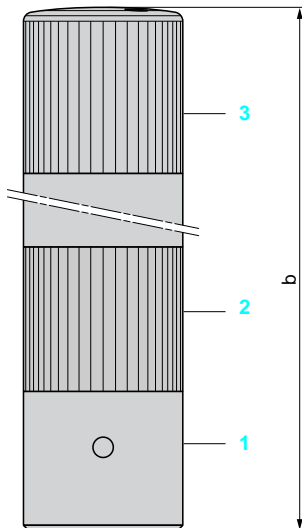

- 1 Base unit XVD C07
- 2 Illuminated or audible signalling unit XVD C●●●
- 3 “Flash” unit XVD C●●●

Number of illuminated or audible signalling units other than “flash” tube	b
1	308
2	371
3	434
4	497

Panel cut-out for direct fixing

On base unit XVD C21 or XVD C07

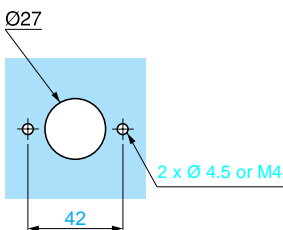

Beacons and indicator banks

Beacons and indicator banks Ø 70 mm
Application, Harmony type XVD

Dimensions

With fixing bases comprising XVB Z0● (aluminium support tube glued into black plastic fixing plate)

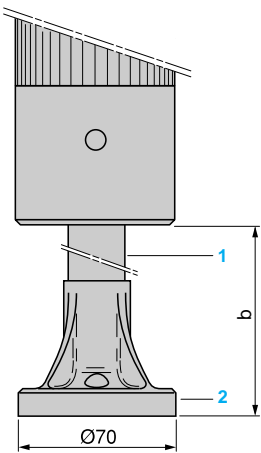

Fixing base comprising XVB Z0● (Ø 25 mm support tube 1 glued into plastic fixing plate 2)

XVB	b
Z02/Z02A	80
Z03/Z03A	380
Z04/Z04A	780

With integral support tube and fixing plate XVD C02

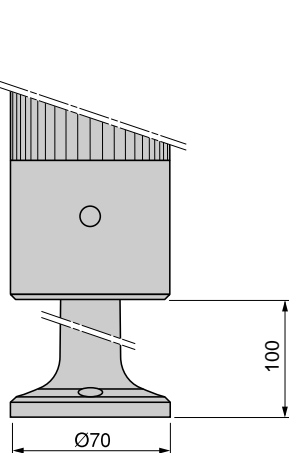

Horizontal support panel cut-out for mounting on fixing plate

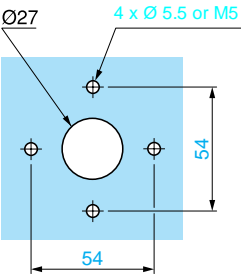

With fixing plate XVB C12 for use on vertical support
Direct mounting on base unit

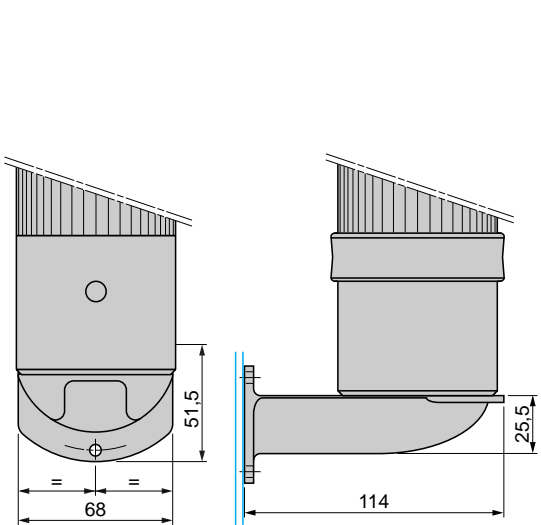

Mounting using fixing base XVB Z0● (aluminium support tube glued into black plastic fixing plate)

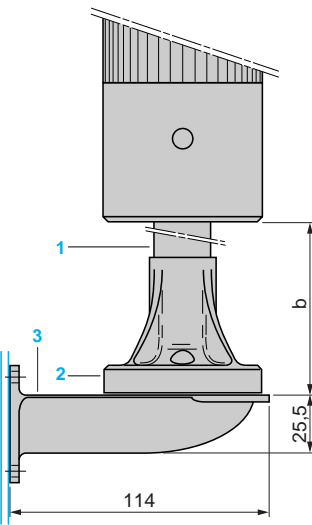

Vertical support panel drillings for mounting fixing plate XVB C12

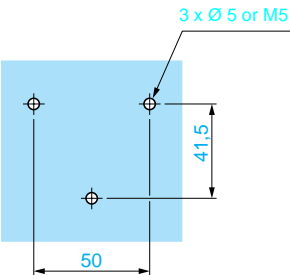

Fixing base comprising XVB Z0● (Ø 25 mm support tube 1 glued into plastic fixing plate 2) mounted on fixing plate XVB C12 for vertical support 3

XVB	b
Z02/Z02A	80
Z03/Z03A	380
Z04/Z04A	780

Installation

Connections

XVD L

XVD C

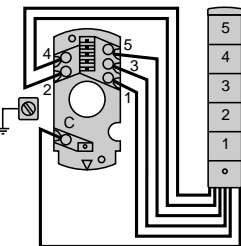
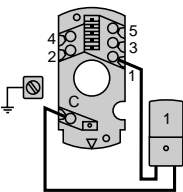

Adjustment of audible signal for buzzers type XVD C9●

- By means of 4 microswitches located in the base of the buzzer:
- 2 switches marked 1 and 2 for selecting continuous or intermittent **mode** (Hz).
 - 2 switches marked 3 and 4 for selecting the **power** (dB) of the audible signal.

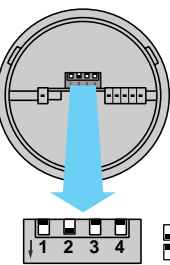

Position of microswitches		Setting
1	2	Mode
1	1	— 2.8 kHz
1	0	— 2.8 kHz
0	1	⏏ 5 Hz (1)
0	0	⏏ 1 Hz
3	4	Power
1	1	90 dB (1)
0	1	85 dB
1	0	80 dB
0	0	70 dB

(1) Factory setting.

Beacons and indicator banks
Rotating mirror beacons, type XVR

General

These rotating beacons are designed for long distance signalling applications.

Characteristics

Conformity to standards			IEC 60947-1, IEC/EN 60947-5-1, UL 508, CSA C22-2-14
Protective treatment	Standard version		"TC"
Ambient air temperature	For storage	°C	- 40...+ 70
	For operation	°C	- 20...+ 50
Electric shock protection	Conforming to IEC 60536 and NF C 20-030		Class I
Degree of protection	Conforming to IEC 60529 and NF C 20-010		IP 65
	Conforming to UL 508 and CSA 22		Type 4X Nema "INDOOR"
Material	Base unit		Glass-reinforced polyamide 6
	Domed lens unit		Polycarbonate
Rated insulation voltage (Ui)	Conforming to IEC 60947-1	V	250
Consumption	Halogen bulbs	mA	≈ 24 V: < 3100
	Incandescent bulbs	mA	≈ 24 V: < 1050
			≈ 120 V: < 210
			≈ 230 V: < 110
Rated impulse withstand voltage	Conforming to IEC 60947-1	kV	U imp = 4
Light source	Halogen bulbs		Bulbs with H1 base fitting: maximum power 70 W
	Incandescent bulbs		Bulbs with BA 15d base fitting: maximum power 25 W
Service life of motor		H	> 2000
Mounting position			Horizontal
Flash frequency		Hz	3
Connection	Maximum clamping capacity	mm²	1 x 1.5 mm²
Cable entry			For ISO M20 x 1.5 cable gland (included)

Dimensions

Panel cut-out

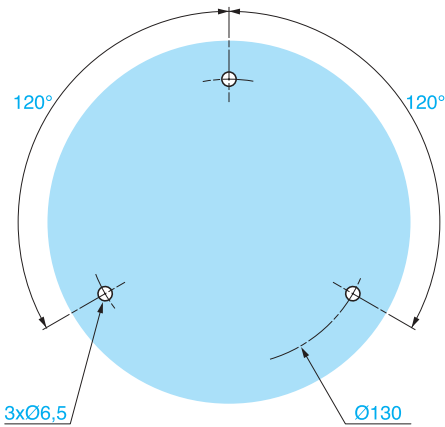
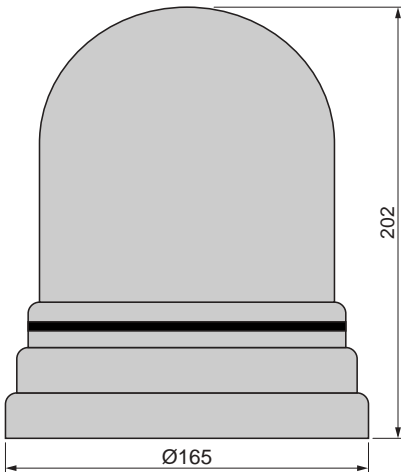

M20 x 1.5 cable gland included

Beacons and indicator banks

Rotating mirror beacons, type XVR



XVR 1000

Rotating mirror beacons

Light source	Supply voltage	Colour	Reference	Weight kg
Halogen bulb included 70 W	≈ 24 V	Green	XVR 1B93	1.165
		Red	XVR 1B94	1.165
		Orange	XVR 1B95	1.165
		Blue	XVR 1B96	1.165
		Yellow	XVR 1B98	1.165
Incandescent bulb included 25 W	≈ 24 V	Green	XVR 1B03	1.165
		Red	XVR 1B04	1.165
		Orange	XVR 1B05	1.165
		Blue	XVR 1B06	1.165
		Yellow	XVR 1B08	1.165
	~ 120 V	Green	XVR 1G03	1.235
		Red	XVR 1G04	1.235
		Orange	XVR 1G05	1.235
		Blue	XVR 1G06	1.235
		Yellow	XVR 1G08	1.235
	~ 230 V	Green	XVR 1M03	1.235
		Red	XVR 1M04	1.235
		Orange	XVR 1M05	1.235
		Blue	XVR 1M06	1.235
		Yellow	XVR 1M08	1.235

Accessories and spare parts

Description	Characteristics	Unit reference	Weight kg
Domed lens unit	Green	XVR 0153	0.335
	Red	XVR 0154	0.335
	Orange	XVR 0155	0.335
	Blue	XVR 0156	0.335
	Yellow	XVR 0158	0.335
Protective grill for domed lens unit	–	XVR 016 (1)	–
Fixing plate for use on vertical support	–	XVR 012	–
Fixing plate for support tube (1/2 NPT)	–	XVR 013	–
Halogen bulbs H1 base fitting, 70 W	24 V	DL1 BRBH	–
Incandescent bulbs BA 15d base fitting, 25 W (sold in lots of 10)	24 V	DL1 BRB	0.100
	120 V	DL1 BRG	0.100
	230 V	DL1 BRM	0.100

(1) This protective grill is only suitable for use with the XVR 1000 rotating mirror beacon, without cable gland fitted.

General

These sirens are designed for long distance signalling applications.

Characteristics

Conformity to standards			IEC 60947-1, IEC/EN 60947-5-1
Protective treatment	Standard version		"TC"
Ambient air temperature	For storage	°C	- 40...+ 70
	For operation	°C	- 40...+ 50
Electric shock protection	Conforming to IEC 60536 and NF C 20-030	kV	~ 120 V and ~ 230 V: class II
		kV	≈ 24 V: class III
Degree of protection	Conforming to IEC 60529 and NF C 20-010		IP 40
Material	Body		Glass-reinforced polyamide 6
	Cone		Butadiene-styrene acrylic
Rated insulation voltage (Ui)	Conforming to IEC 60947-1	V	250
Consumption		mA	≈ 24: 440
		mA	~ 120: 110
		mA	~ 230: 55
Frequency	1-tone	Hz	1000 ± 10%
	2-tone	Hz	700 and 800 ± 15%
Rated impulse withstand voltage	Conforming to IEC 60947-1	kV	~ 120 V and ~ 230 V: U imp = 4
		kV	≈ 24 V: U imp = 1.5
Mounting position			All positions
Connection	Maximum clamping capacity	mm²	1 x 1.5 with cable end

References



XVS B●

Sirens				
Description	Supply voltage	Number of tones	Reference	Weight kg
Sirens 106 db	≈ 24 V	1	XVS B1	0.860
		2	XVS B2	0.860
	~ 120 V	1	XVS G1	0.860
		2	XVS G2	0.860
	~ 230 V	1	XVS M1	0.860
		2	XVS M2	0.860

Dimensions

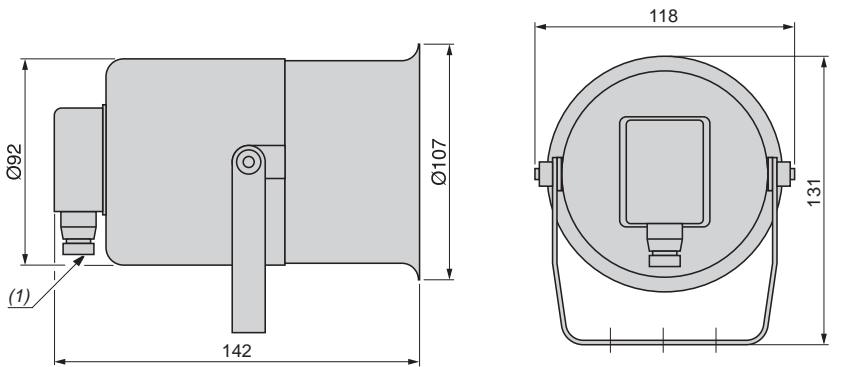

(1) Cable gland n° 7 (DIN Pg 7), included.

